

LABOR AND MATERIALS

1 Copper Connection $\frac{3}{4}$	\$ 2.29
1 Lead-Cock $\frac{3}{4}$	\$ 2.75
1 Curb Valve $\frac{3}{4}$ in.	\$ 2.75
T. S. & V.	
1 Service box { Short $3\frac{1}{2} \times 4\frac{1}{2}$ }	\$ 4.25
Old returned { Long $4\frac{1}{2} \times 5\frac{1}{2}$ }	
Buff or Raway	
25 Ft. $\frac{3}{4}$ in. { Copper } Pipe at 35 \$ 8.75	
{ G.I. }	
{ C.I. }	
Nipples..... in. at.....	\$
Bushings..... to..... in. at.....	\$
Red'g / Inc'g Coupl'gs..... to..... in. at.....	\$
Union..... in. at.....	\$
Meter..... in. at.....	\$
Lead Joints at.....	\$
Compound Joints at.....	\$
Hrs. Water Maint. Man-1 at.....	\$
2 Hrs. Water Maint. Man-2 at 1.02 \$ 2.04	
2 Hrs. Labor..... at 91 \$ 1.82	
Hrs. Labor..... at.....	\$
Hrs. Compressor at.....	\$
Compensation Ins. at \$ 2.24 per C. \$ 0.9	
Trucking.....	\$ 1.85
Pav't Patch.....	\$
Taps by McGinnis.....	\$
O'head.....	\$
<u>\$ 37.79</u>	

1-1950

St. 15
Pl. 7
Ave. No. 7

Cunningham

Name of Owner
M. Barowitz

Labor and Mat'l. Report Dec 6 1949

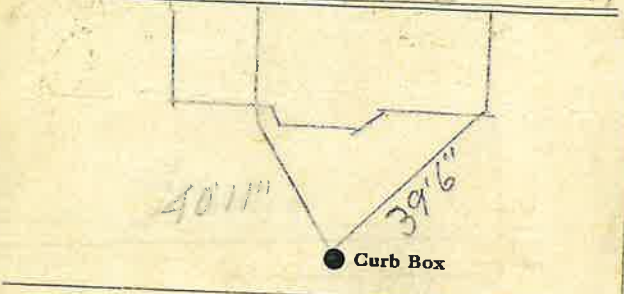

6 Main Elev. of Main at tap 5
Gate at ● Gate at ●

● Curb Box