

Labor and Materials		
1	Lead Connection 12x4 Top only	\$
1	Curb Cock 4" Tee 150000 + Galv	\$
1	Service Box (Short 3 1/2 x 4 1/2) Galv	\$
	Old returned (Long 4 1/2 x 5 1/2) + Pipe	\$
398	Ft. 4" in. G. I. Pipe at	\$
1	Nipples 4" in. at Plug	\$
	Bushings to in. at	\$
	Red'g Coup to in. at	\$
	Inc'g Coup to in. at	\$
	Union in. at	\$
	Meter in. at	\$
	Cu. Yds. Br. Stone at	\$
	Cu. Yds. Sand at	\$
	Bags Cement at	\$
	Paving Brick (Mack Red Asphalt) at	\$
	Hrs. Foreman at	\$
	Hrs. Common Labor at	\$
	Hrs. Mason at	\$
	Hrs. at	\$
	Hrs. at	\$
	Builders' Use of Water	\$
	used 220 lbs. Lead at	\$
	60 lbs. Steel at	\$
	at	\$
	at	\$
	at	\$
	Total	\$

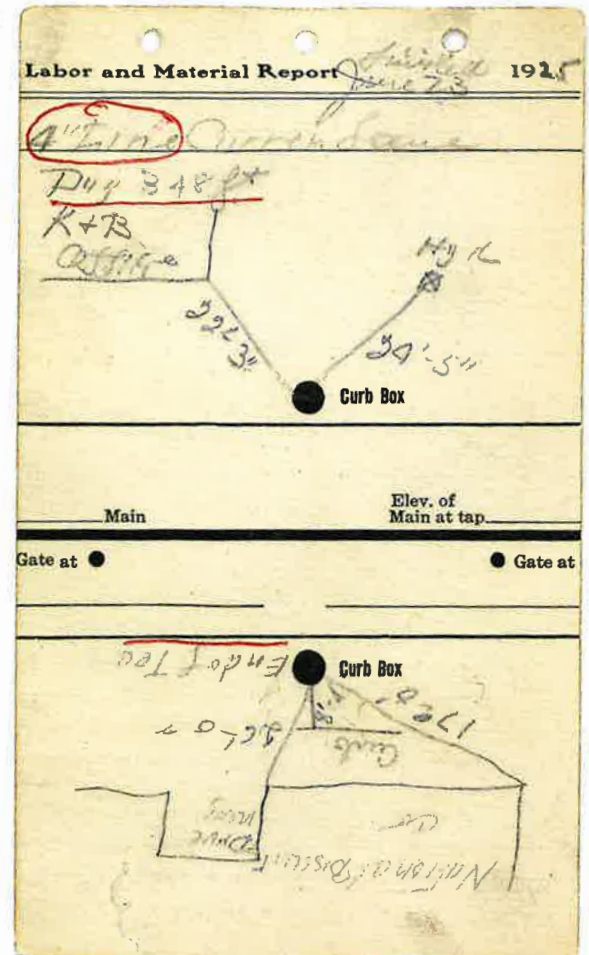

Top: 4" Line Curran Lane dug 348 ft K & B Office 22' 3" 24' 5" Hyd

Bottom: National Biscuit Company Drive way Curb 17' 0" 26' 0" (curb to box) 8' End of Tee