

LABOR AND MATERIALS

1	Copper Lead	} Connection	$\frac{3}{4}$	in.	\$
1	Curb				
1	Service box Old returned	{ Short $3\frac{1}{2}$ x $4\frac{1}{2}$ Long $4\frac{1}{2}$ x $5\frac{1}{2}$ }			\$
26	Ft. $\frac{3}{4}$ in.				
	Nipples	in. at	\$		
	Bushings	to in. at	\$		
	Red'g Inc'g	} Coupl'gs	to	in. at	\$
	Union				
	Meter	in. at	\$		
	Compound Joints	at	\$		
	Maintenance Foreman		\$		
	Hrs. Water Maint. Man—1	at	\$		
	Hrs. Water Maint. Man—2	at	\$		
	Hrs. Garage Foreman	at	\$		
	Hrs. Labor	at	\$		
	Hrs. Compressor	at	\$		
	Trucking		\$		
	Pav't Patch		\$		
			\$		
			\$		
			\$		
			\$		

DAVIS

St. No. 28

Name of Owner

Labor and Mat'l. Report

APR. 16 1935

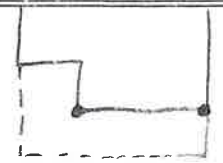

29'5" 26'4"

● Curb Box

4" Main

Elev. of Main at tap 5' 1/2

Gate at ●

● Gate at

● Curb Box

OLD SHUT OFF AT MAIN