

LABOR AND MATERIALS

1-3	Copper	} Connection		\$
	Lead			
1	Curb	} Cock Valve T.S. & V.	3 in.	\$
1	Service box	} Short 3 1/2 x 4 1/2		\$
	Old returned		Long 4 1/2 x 5 1/2	
346	3/4	} Copper	Pipe at	\$
	Nipples	in. at		\$
	Bushings	to in. at		\$
1	Red'g	} Coupl'gs	to in. at	\$
	Inc'g			
	Union	in. at		\$
	Meter	in. at		\$
	Compound Joints	at		\$
	Maintenance Foreman			\$
	Hrs. Water Maint. Man-1	at		\$
	Hrs. Water Maint. Man-2	at		\$
	Hrs. Garage Foreman	at		\$
	Hrs. Labor	at		\$
	Hrs. Compressor	at		\$
	Trucking			\$
	Pav't Patch			\$
				\$
				\$
				\$
				\$
				\$

DIX

Ave. No. 134

Name of Owner

INSURANCE AGENCY

Labor and Mat'l. Report

MARCH 29 1928



33'-0" 4'4"

● Curb Box

12" Main

Elev. of Main at tap

Gate at ●

● Gate at

THAWING CABLE BOX ● Curb Box

67'10" 65'4"

LSM-5C-6-1-67

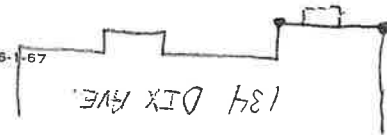

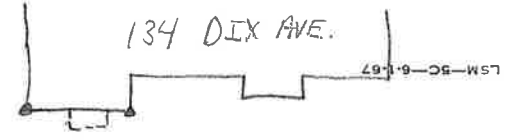

67'10" 65'4"

● Curb Box THAWING CABLE BOX

● Gate at ● Gate at

Elev. of Main at tap 12" Main

● Curb Box

33'-0" 41'4"



Labor and Mat'l. Report MARCH 29 19 28

INSURANCE AGENCY

Name of Owner

DIX Ave. No. 134