

LABOR AND MATERIALS

1	Copper	Connection	3/4"	\$
1	Lead	Cock	3/4" oriseal.	\$
1	Curb	Valve		
		T. S. & V.		
1	Service box	Short 3 1/2 x 4 1/2		
	Old returned	Long 4 1/2 x 5 1/2		
		Buff or Rdway		\$
10	Ft.	3/4" in.	{ Copper G.I. G.I. } Pipe at	\$
	Nipples	in. at		\$
	Bushings	to in. at		\$
	Red'g			
	Inc'g	Coupl'gs. to in. at		\$
	Union	in. at		\$
	Meter	in. at		\$
	Lead Joints at			\$
	Compound Joints at			\$
	Maintenance Foreman			\$
	Hrs. Water Maint. Man-1 at			\$
	Hrs. Water Maint. Man-2 at			\$
	Hrs. Garage Foreman at			\$
	Hrs. Labor at			\$
	Hrs. Compressor at			\$
	Compensation Ins. at \$	per C		\$
	Trucking			\$
	Pav't Patch			\$
	Tap by Bissard & Co.			\$
		11-4-65		\$
	O'head			\$
				\$

East St. Ave. No. 1

Name of Owner
William Goodrich

Labor and Mat'l. Report Nov. 4 1965

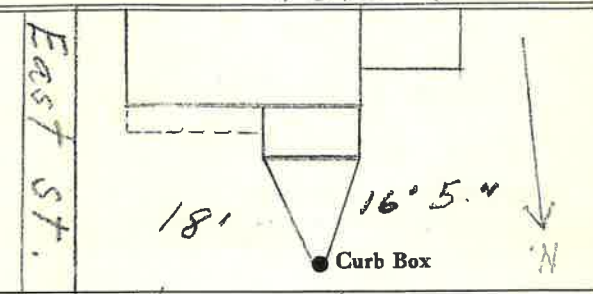

New St.
4" Main Elev. of Main at tap 5'

Gate at • Gate at

• Curb Box
Tap on new St.