

LABOR AND MATERIALS

1 Copper Lead	Connection	3/4	\$ 1.35
1 Curb	Cock Valve T. S. & V.	3/4 in.	\$ 1.88
1 Service Box	Short 3/2x4 1/2 Long 4 1/2x5 1/2 Buff. or Rdway		\$ 1.82
Old returned			
24 Ft. 3/4 in.	Copper Galv. Iron Cast Iron	Pipe at 20	\$ 4.80
Nipples	in. at		\$
Bushings	to in. at		\$
Red'g Inc'g	Couplings to in. at		\$
Union	in. at		\$
Meter	in. at		\$
Lead Joints	at		\$
Leadite Joints	at		\$
1 Hrs. ^{Sp. Ch.} Foreman	at	.55	\$.55
1 Hrs. Chauffeur	at	.68 3/4	\$.69
4 Hrs. Tapper	at	"	\$ 2.75
6 Hrs. Labor	at	.55	\$ 3.30
Hrs. Labor	at		\$
Hrs. Compressor	at		\$
Compensation Ins.			\$.23
Trucking			\$ 1-
Builders Use of Water	1/2 Patch (Sewer)		\$ 2.50
Tophy Hessel			\$
			\$
			\$
			\$
			\$ 20.87

H.

8 1942

St.

Pl.

Ave. No. 7

Name of Owner

Jones

Labor and Mat'l. Report

Mar 27

1942

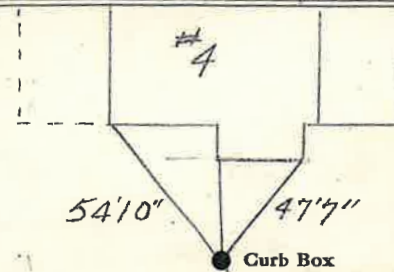

6 11

Main

Elev. of Main at tap

5

Gate at

Gate at

24' to MAIN

Curb Box

TAX ID # 302.11-4-2