

LABOR AND MATERIALS

1	Copper } Connection	$\frac{3}{4}$	\$
	Lead }		
1	Curb } Cock Valve	$\frac{3}{4}$ in.	\$
	T.S. & V. }		
1	Service box } Short $3\frac{1}{2}$ x $4\frac{1}{2}$		\$
	Old returned } Long $4\frac{1}{2}$ x $5\frac{1}{2}$		
25	Ft. $\frac{3}{4}$ in. } Copper		\$
		G.P.	
		C.I.	
		} Pipe at	
	Nipples	in. at	\$
	Bushings	to in. at	\$
	Red'g } Inc'g	Coupl'gs to in. at	\$
	Union	in. at	\$
	Meter	in. at	\$
			\$
	Compound Joints	at	\$
	Maintenance Foreman		\$
	Hrs. Water Maint. Man-1	at	\$
	Hrs. Water Maint. Man-2	at	\$
	Hrs. Garage Foreman	at	\$
	Hrs. Labor	at	\$
	Hrs. Compressor	at	\$
			\$
	Trucking		\$
	Pav't Patch		\$
			\$
			\$
			\$
			\$

St. Elizabeth Ave. No. 15
 Name of Owner

Labor and Mat'l. Report AUG. 6 1934

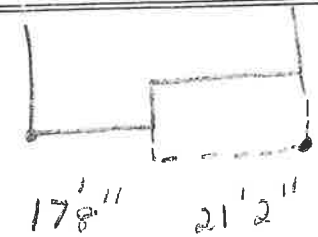

● Curb Box

6" Main Elev. of Main at tap 5'

Gate at ● Gate at

● Curb Box

OLD SHUT OFF AT MAIN