

### LABOR AND MATERIALS

1	Copper Lead	Connection	3 4		\$
1	Curb	Cock Valve T.S. & V.	3 4 in.		\$
1	Service box Old returned	Short 3 1/2 x 4 1/2 Long 4 1/2 x 5 1/2			\$
11	Ft.	3 4 in.	Copper G.I. G.I.	Pipe at	\$
	Nipples	in. at			\$
	Bushings	to in. at			\$
	Red'g Inc'g	Coupl'gs	to in. at		\$
	Union	in. at			\$
	Meter	in. at			\$
	Compound Joints	at			\$
	Maintenance Foreman				\$
	Hrs. Water Maint. Man-1	at			\$
	Hrs. Water Maint. Man-2	at			\$
	Hrs. Garage Foreman	at			\$
	Hrs. Labor	at			\$
	Hrs. Compressor	at			\$
	Trucking				\$
	Pav't Patch				\$
					\$
					\$
					\$
					\$
					\$
					\$

St.  
No. 18

ELIZABETH Ave. No. 18

Name of Owner

Labor and Mat'l. Report NOV. 11 19 29

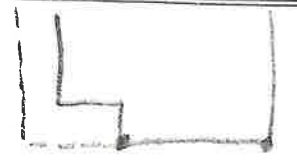

15' 24 1/2"

● Curb Box

6" Main Elev. of Main at top 5'

Gate at ● Gate at

● Curb Box

OLD LOT SHUT OFF