

LABOR AND MATERIALS

1	Copper	} Connection $\frac{3}{4}$	\$
	Lead		
1	Curb	} Cock Valve T.S. & V. $\frac{3}{4}$ in.	\$
1	Service box	} Short $3\frac{1}{2} \times 4\frac{1}{2}$ Long $4\frac{1}{2} \times 5\frac{1}{2}$	\$
	Old returned		
13	Ft. $\frac{3}{4}$ in.	} Copper C.P. C.I.	Pipe at \$
	Nipples	in. at	\$
	Bushings	to in. at	\$
	Red'g	} Coupl'gs to in. at	\$
	Inc'g		
	Union	in. at	\$
	Meter	in. at	\$
			\$
	Compound Joints	at	\$
	Maintenance Foreman		\$
	Hrs. Water Maint. Man—1	at	\$
	Hrs. Water Maint. Man—2	at	\$
	Hrs. Garage Foreman	at	\$
	Hrs. Labor—	at	\$
	Hrs. Compressor	at	\$
			\$
	Trucking		\$
	Pav't Patch		\$
			\$
			\$
			\$
			\$

St. ELIZABETH No. 20

Name of Owner

Labor and Mat'l. Report AUG. 1 1929

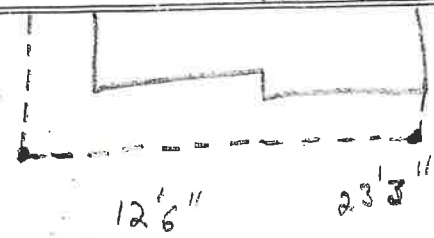

● Curb Box

6" Main Elev. of Main at tap 4 1/2'

Gate at ● Gate at

● Curb Box

OLD TAP SHUT OFF
AT MAIN