

## LABOR AND MATERIALS

1. Copper Lead Connection $\frac{3}{4}$ in.	\$ 2.87
1. Curb Cock Valve $\frac{3}{4}$ in. T. S. & V.	\$ 3.62
1. Service box Old returned	\$ 4.68
Short $3\frac{1}{2} \times 4\frac{1}{2}$	
Long $4\frac{1}{2} \times 5\frac{1}{2}$ Buffer Rdway	
9 Ft. $\frac{3}{4}$ in. Copper Pipe at	\$ 2.88
Nipples in. at	\$
Bushings to in. at	\$
Red'g Inc'g Coupl'gs to in. at	\$
Union in. at	\$
Meter in. at	\$
Lead Joints at	\$
Compound Joints at	\$
Hrs. Water Maint. Man-1 at	\$
14 Hrs. Water Maint. Man-2 at	\$ 1.02 \$ 14.28
17 Hrs. Labor at	\$ 9.1 \$ 15.47
Hrs. Labor at	\$
3 Hrs. Compressor at	\$ 1.20 \$ 3.60
Compensation Ins. at \$ 2.18. per C.	\$ 6.5
Trucking	\$ 2.00
Pav't Patch	\$ 14.85
O'head	\$
	\$ 64.90

102

St. Elm  
-Pl- Ave. No. 3

Name of Owner

*Yaffee*

Labor and Mat'l. Report

*Sept 23 19 44*

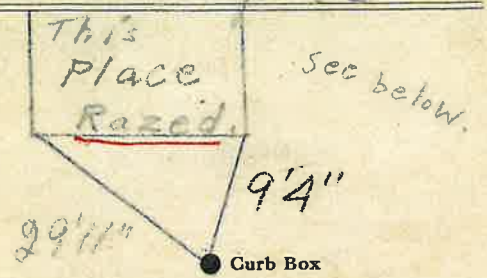

6 Main Elev. of Main at tap 5

Gate at ● Gate at ●

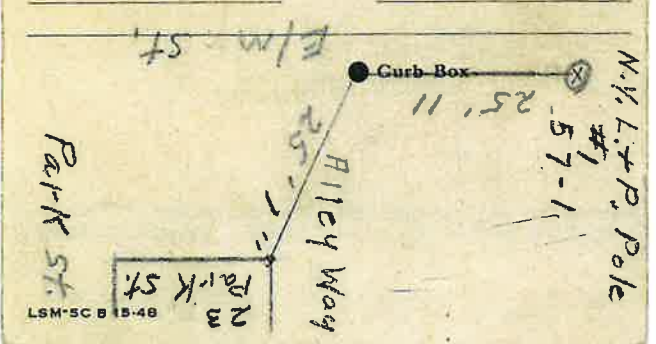

N.Y.L. & P. Pole

#1  
-57-1

11' 52"

Curb Box

Alley Way

25' 1"

23  
Park St

Park St.

Elm St.

LSM-3C B 19-48

Gate at

Gate at

Elev. of  
Main at top

Main  
6

Curb Box

29' 11"

9' 4"

See below

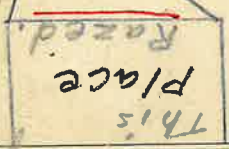

This  
Place  
Razed.

Labor and Mat'l. Report  
Sept 23 19 49

Name of Owner

Yaffor

St.  
Pl.  
Ave. No.

Elm

102