

## LABOR AND MATERIALS

1	Copper	Connection	<i>3/4</i>		\$ 2.94
1	Lead	Cock			
1	Curb	Valve	<i>3/4</i>	in.	\$ 3.71
		T. S. & V.			
1	Service box	Short $3\frac{1}{2} \times 4\frac{1}{2}$			
	Old returned	Long $4\frac{1}{2} \times 5\frac{1}{2}$			
		Buff or Rdway			\$ 5.90
18	Ft.	Copper		<i>30</i>	\$ 5.40
	<i>3/4</i>	G.I.			
	in.	C.I.			
		Pipe at			
	Nipples	in. at			\$
	Bushings	to in. at			\$
	Red'g				
	Inc'g	Coupl'gs to in. at			\$
	Union	in. at			\$
	Meter	in. at			\$
	Lead Joints at				\$
	Compound Joints at				\$
2	Hrs. Water Maint. Man-1	at	<i>1.01</i>		\$ 2.02
4	Hrs. Water Maint. Man-2	at	<i>91</i>		\$ 3.64
11	Hrs. Labor	at	<i>80</i>		\$ 9.80
	Hrs. Labor	at			\$
	Hrs. Compressor at				\$
	Compensation Ins. at \$	per C			\$ 32
	Trucking				\$ 1.00
	Pav't Patch	<i>Before Paving</i>			\$
	<i>Tap by McGowan</i>				\$
	O'head				\$
					\$ 33.73

118

St.  
"Pl."  
Ave. No. *59*

Name of Owner

*Ernst*

Labor and Mat'l. Report

*Aug 21* 1948

Elm St

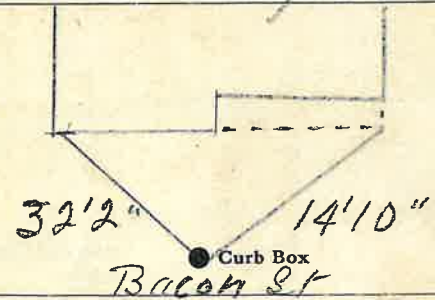

6" Main

Elev. of  
Main at tap

5'

Gate at ●

● Gate at

*This Tap on Bacon St.*

● Curb Box