

1 - 1" X 1" X 3/4" Brass Tee.

LABOR AND MATERIALS

1	Copper Lead	Connection	3/4" Male Adapters	\$
1	Curb	Cock Valve T.S. & V.	3/4" in.	\$
1	Service box	Short 3 1/2 x 4 1/2	}	\$
	Old returned	Long 4 1/2 x 5 1/2		
		Buff or Rdway		
13	Ft.	3/4" in.	Copper G.I. Pipe at	\$
	Nipples	in. at		\$
	Bushings	to in. at		\$
	Red'g. Inc'g.	Coupl'gs. to in. at		\$
	Union	in. at		\$
	Meter	in. at		\$
	Lead Joints at			\$
	Compound Joints at			\$
	Maintenance Foreman			\$
	Hrs. Water Maint. Man-1 at			\$
	Hrs. Water Maint. Man-2 at			\$
	Hrs. Garage Foreman at			\$
	Hrs. Labor at			\$
	Hrs. Compressor at			\$
	Compensation Ins. at \$	per C		\$
	Trucking			\$
	Pav't Patch			\$
	Tap by Miller, Kelly			\$
	4 Co. 6-28-60			\$
	O'head			\$

✓

Exeter

St. Pl. Ave. No. 10

Name of Owner Alma Minor

Labor and Mat'l. Report June 28 1960

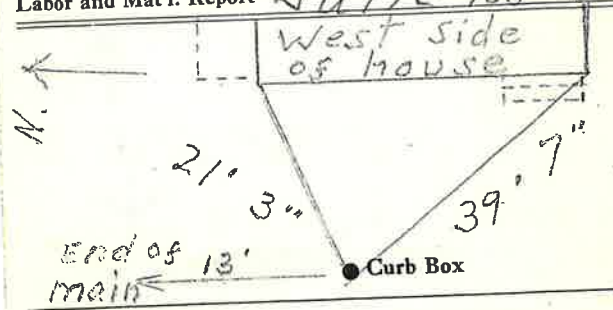

1" Copper Main Elev. of Main at tap 5'

Gate at • Gate at •

• Curb Box

This Tap off End of 1" Copper Main 13' From Curb box. 1960