

Labor and Materials

1	Copper } Connection, $\frac{3}{4}$	\$3.20	
	Lead		
1	Curb } Cock Valve } $\frac{3}{4}$ in.	\$1.00	
	T.S. & V.		
1	Service Box } Short $3\frac{1}{2} \times 4\frac{1}{2}$	\$1.20	
	Old returned } Long $4\frac{1}{2} \times 6\frac{1}{2}$		
28	Ft. $\frac{3}{4}$ in. } Copper } Pipe at.	\$1.6	
	Nipples..... in. at.	\$	
	Bushings..... to..... in. at.	\$	
1	Red'g } Couplings, $\frac{3}{4}$ Brass	\$1.5	
	Inc'g }		
	Union..... in. at.	\$	
	Meter..... in. at.	\$	
	Lbs. Br. Stone at.	\$	
	Lbs. Sand at.	\$	
	Bags Cement at.	\$	
	Paving Brick } Mack } at	\$	
	Lead Joints at.	\$	
	Leadite Joints at.	\$	
3	Hrs. Foreman at..... 62.5	\$18.8	
14	Hrs. Common Labor at..... 50	\$7.00	
	Hrs. Common Labor at.	\$	
	Hrs. Mason at.	\$	
	Hrs. Mason's Helper at.	\$	
	Hrs. Compressor at.	\$	
	Compensation Ins..... 25	\$	
	Trucking..... 100	\$10.00	
	Builders' Use of Water.	\$	
Total		\$21.94	

26-158

Labor and Material Report

Sept

1926

18 FIFTH ST.

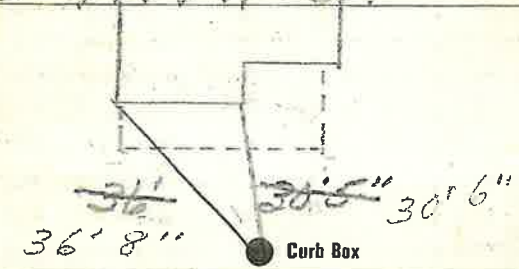

4" Main

Elev. of Main at tap 5'

Gate at ●

● Gate at

● Curb Box