

LABOR AND MATERIALS

1	Copper	{	Connection	3/4"	\$	2.29
	Lead	}				
	Curb	{	Cock Valve	Used Same	\$	
		}	T. S. & V.	in.		
1	Service box	{	Short	3 1/2 x 4 1/2		
	Old returned	}	Long	4 1/2 x 5 1/2		
			Buff or Rdway			\$ 4.25
266	Ft.	3/4	in.			
			Copper	Pipe at	35	\$ 9.10
			G.I.			
			G.I.			
	Nipples		in.	at	\$	
1	Bushings	1"	to	3/4" in.	at	\$
	Red'g	{	Coupl'gs	to	in.	at
	Inc'g	}				\$
	Union		in.	at	\$	
	Meter		in.	at	\$	
	Lead Joints	at			\$	
	Compound Joints	at			\$	
3	Hrs.	Water Maint. Man-1	at	1.12	\$	3.36
6	Hrs.	Water Maint. Man-2	at	1.02	\$	6.12
16	Hrs.	Labor	at	91	\$	14.56
	Hrs.	Labor	at		\$	
	Hrs.	Compressor	at		\$	
	Compensation Ins.	at \$	per C.		\$	54
	Trucking				\$	1-
	Pay't Patch	B.P.			\$	
	1 - 3/4" Cou to Fe. Adaptor				\$	
	O'head				\$	
\$ 41.22						

2409

100-1350

Before Taving

St.

Pl:

Ave. No.

43

First

Name of Owner

Wm Brown

Labor and Mat'l. Report

July 21 19 50

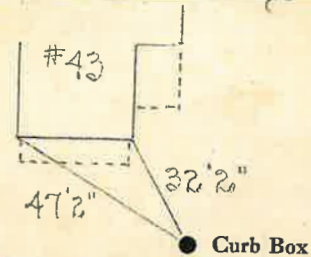

Curb Box

6 Main

Elev. of Main at tap

5'

Gate at

Gate at

TAX ID # 309.11-6-13

Curb Box