

LABOR AND MATERIALS

1	Copper Lead	Connection	3/4"	\$
1	Curb	Cook Valve T.S. & V.	3/4 in.	\$
1	Service box	Short 3 1/2 x 4 1/2		
	Old returned	Long 4 1/2 x 5 1/2		\$
11	Ft.	3/4 in. Copper G.I. G.I.	Pipe at	\$
	Nipples	in. at		\$
	Bushings	to in. at		\$
	Red'g Inc'g	Coupl'gs to in. at		\$
	Union	in. at		\$
	Meter	in. at		\$
	Lead Joints	at		\$
	Compound Joints	at		\$
	Maintenance Foreman			\$
	Hrs. Water Maint. Man-1	at		\$
	Hrs. Water Maint. Man-2	at		\$
	Hrs. Garage Foreman	at		\$
	Hrs. Labor	at		\$
	Hrs. Compressor	at		\$
	Compensation Ins.	at \$ per C		\$
	Trucking			\$
	Pav't Patch			\$
	Tap by Danovan & Lareau			\$
	O'head	10-23-67.		\$

Rd
St.
Pl.
Ave. No. 17
Fort Amberst

Name of Owner

Dayton Stemple

Labor and Mat'l. Report

Oct. 23 1967

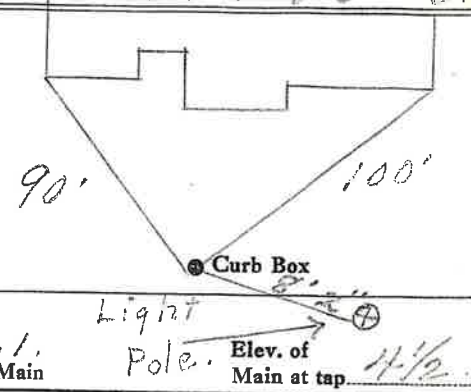

Gate at ●

● Gate at

● Curb Box