

LABOR AND MATERIALS

1	Copper Lead	Connection	3/4"	\$
1	Curb	Cock Valve	3/4" in.	\$
1	Service box	Short 3 1/2 x 4 1/2		
	Old returned	Long 4 1/2 x 5 1/2		
		Buff or Rdway		\$
26	3/4 in.	Copper	Pipe at	\$
		Gal.		
		C.I.		
	Nipples	in. at		\$
	Bushings	to in. at		\$
	Red'g	Coupl'gs	to in. at	\$
	Inc'g			
	Union	in. at		\$
	Meter	in. at		\$
	Lead Joints	at		\$
	Compound Joints	at		\$
	Maintenance Foreman			\$
	Hrs. Water Maint. Man	1 at		\$
	Hrs. Water Maint. Man	2 at		\$
	Hrs. Garage Foreman	at		\$
	Hrs. Labor	at		\$
	Hrs. Compressor	at		\$
	Compensation Ins.	at \$ per C.		\$
	Trucking			\$
	Pav't Patch			\$
	Tap by Gifford			\$
	11-29-56			\$
	O'head			\$

N.G.F. V

St. Rd.  
Pl.  
Ave. No. 32

Name of Owner  
Lee Brown

Labor and Mat'l. Report Nov. 29 19 56

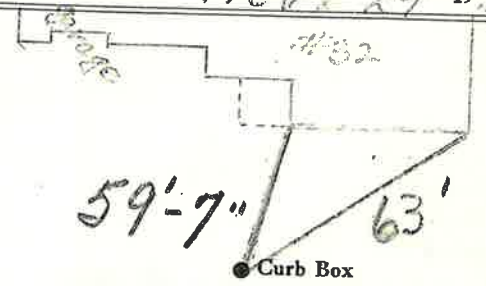

6" Main  
Elev. of Main at tap 5'  
Gate at ● Gate at ●

● Curb Box