

LABOR AND MATERIALS

1	Copper Lead	Connection	3/4"	\$	308
1	Curb	Cock Valve T.S. & V.	3/4 in.	\$	289
1	Service box - Old returned	Short 3 1/2 x 4 1/2 Long 4 1/2 x 5 1/2 Buff or Rdway		\$	432
11	Ft. 3/4 in.	Copper G.I. C.I.	Pipe at 45	\$	495
	Nipples	in. at		\$	
	Bushings	to in. at		\$	
	Red'g } Inc'g }	Coupl'gs	to in. at	\$	
	Union	in. at		\$	
	Meter	in. at		\$	
	Lead Joints	at		\$	
	Compound Joints	at		\$	
	Maintenance Foreman			\$	
	Hrs. Water Maint. Man-1	at		\$	
6	Hrs. Water Maint. Man-2	at 1.613		\$	968
	Hrs. Garage Foreman	at		\$	
12	Hrs. Labor	at 1.30		\$	1560
	Hrs. Compressor	at		\$	
	Compensation Ins. at \$	5686 per C		\$	144
	Trucking			\$	1.50
	Pav't Patch			\$	9.00
	Tap by Gifford & Co.				\$
	10-29-56				\$
	O'head			\$	
				\$	5346

St. Pl. Ave. No. 71
 Et. Amberst Rd.

Name of Owner

Mae Dolan

Labor and Mat'l. Report

Oct. 29 1956

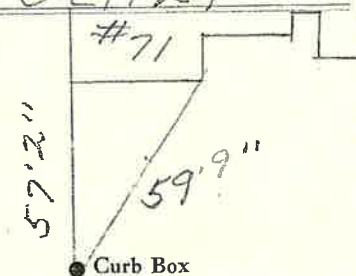

6" Main

Elev. of Main at tap 5'

Gate at ●

● Gate at

● Curb Box