

LABOR AND MATERIALS

Copper	} Connection	_____	\$
Lead		_____	
Curb	} Cock Valve T. S. & V. }	_____ in.	\$
		_____	
		_____	
Service box	} Short 3 1/2 x 4 1/2 } Long 4 1/2 x 5 1/2 }	_____	\$
Old returned		_____	
Ft. 3/4 in.	} Copper } } G.I. } } C.I. }	Pipe at _____	\$
Nipples		_____ in. at _____	\$
Bushings	_____ to _____ in. at _____	\$	
Red'g } Inc'g }	} Coupl'gs. _____ to _____ in. at _____	\$	
Union		_____ in. at _____	\$
Meter	_____ in. at _____	\$	
Compound Joints	at _____	\$	
Maintenance Foreman	_____	\$	
Hrs. Water Maint. Man-1	at _____	\$	
Hrs. Water Maint. Man-2	at _____	\$	
Hrs. Garage Foreman	at _____	\$	
Hrs. Labor	at _____	\$	
Hrs. Compressor	at _____	\$	
Trucking	_____	\$	
Pav't Patch	_____	\$	
	_____	\$	
	_____	\$	
	_____	\$	
	_____	\$	
	_____	\$	

St. FRANKLIN  
~~Pl.~~  
 Ave. No. 21  
 Name of Owner \_\_\_\_\_

Labor and Mat'l. Report 1993

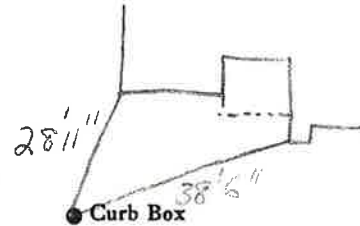

Main \_\_\_\_\_ Elev. of Main at tap \_\_\_\_\_  
 Gate at ● \_\_\_\_\_ ● Gate at \_\_\_\_\_

● Curb Box