

### LABOR AND MATERIALS

1	Copper Lead	Connection	7"	\$	4.18
1	Curb	Cock Valve	7" in.	\$	5.19
		T. S. & V.			
1	Service box	Short 3 1/2 X 4 1/2			
	Old returned	Long 4 1/2 X 5 1/2			
		Buf or Rdway		\$	4.68
24	Ft. 1" in.	Copper Pipe at	40	\$	9.60
		G. I.			
		C. I.			
	Nipples	in. at		\$	
	Bushings	to in. at		\$	
	Red'g			\$	
	Inc'g	Coupl'gs to in. at		\$	
	Union	in. at		\$	
	Meter	in. at		\$	
	Lead Joints	at		\$	
	Compound Joints	at		\$	
	Hrs. Water Maint. Man-1	at		\$	
18	Hrs. Water Maint. Man-2	at	1.02	\$	18.36
	Hrs. Labor	at		\$	
42	Hrs. Labor	at	91	\$	38.22
6	Hrs. Compressor	at	1.20	\$	7.20
	Compensation Ins.	at \$2.18 per C.		\$	1.23
	Trucking			\$	2.00
	Pay't Patch			\$	17.85
	Taps by Watson's Inc.				
	O'head			\$	
				\$	95.51

63

~~St~~  
~~Bl~~  
 Ave. No. 13

Name of Owner  
Parson Garage

Labor and Mat'l. Report July 7 1949

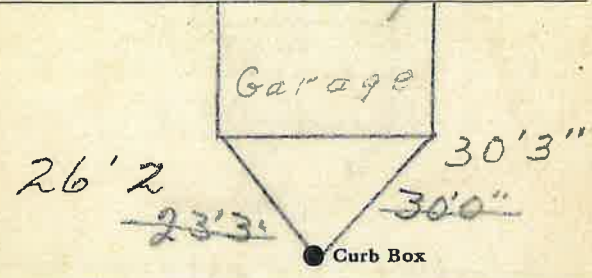

6 Main Elev. of Main at tap 6  
 Gate at ● ● Gate at

● Curb Box

## LABOR AND MATERIALS

Copper	}	Connection.....	\$	
Lead				
Curb	{	Cock Valve		
	{	T. S. & V.		
	}	..... in.	\$	
Service Box	{	Short 3 1/4 x 4 1/2		
Old returned	{	Long 4 1/2 x 5 1/2		
	}	Buffer Rdway		
		..... \$		
Ft.....	{	Copper		
..... in.	{	Galv Iron		
	}	Cast Iron		
		..... Pipe at.....	\$	
Nipples.....		..... in. at	\$	
Bushings		..... to..... in. at	\$	
Red'g	{	Couplings..... to..... in. at	\$	
Inc'g	}			
Union.....		..... in. at	\$	
Meter.....		..... in. at	\$	
Lead Joints at			\$	
Leadite Joints at			\$	
Hrs. Foreman at			\$	
Hrs. Chauffeur at			\$	
Hrs. Tapper at			\$	
Hrs. Labor at			\$	
Hrs. Labor at			\$	
Hrs. Compressor at			\$	
Compensation Ins.			\$	
Trucking			\$	
Builders Use of Water			\$	
			\$	
			\$	
			\$	
			\$	
			\$	
			\$	

St. 13  
 Pt. 13  
 Ave. No. 16

Frederick

**Name of Owner**

---

**Labor and Mat'l. Report**    SEP 6 1939    19

Empire Storage

26'-2"      30'-13"      35'-5"

1" Line      Curb Box

Main Goadway Box      Elev. of Main at tap

Gate at ●      ● Gate at

Curb Box

*Sprinkler System*

LABOR AND MATERIALS

1 Copper Lead } Connection <sup>3/4"</sup> ----- \$

1 Curb { Cock Valve } 1" (wheel in.) ----- \$

1 Service Box { T-S. & V. } ----- \$

Old returned { Short 3/2x4 1/2 } ----- \$

{ Long 4/2x5 1/2 } ----- \$

{ Buff. or Rdway } ----- \$

23 Ft. 1 in. { Copper } Pipe at ----- \$

{ Galv Iron } ----- \$

{ Cast Iron } ----- \$

Nipples ----- in. at ----- \$

Bushings ----- to ----- in. at ----- \$

Red'g } Couplings ----- to ----- in. at ----- \$

Inc'g } ----- \$

Union ----- in. at ----- \$

Meter ----- in. at ----- \$

Lead Joints at ----- \$

Leadite Joints at ----- \$

Hrs. Foreman at ----- \$

Hrs. Chauffeur at ----- \$

Hrs. Tapper at ----- \$

Hrs. Labor at ----- \$

Hrs. Labor at ----- \$

Hrs. Compressor at ----- \$

Compensation Ins. ----- \$

Trucking ----- \$

Builders Use of Water ----- \$

----- \$

----- \$

----- \$

----- \$

----- \$

St. 13  
Pt. Ave. No. 76

Fredella

Name of Owner

Labor and Mat'l. Report

100.9

1918

● Curb Box

Main Elev. of Main at tap

Gate at ● Gate at ●

● Curb Box

Garage

St. 13  
 Pt. 13  
 Ave. No. 76

Name of Owner \_\_\_\_\_

Labor and Mat'l. Report Jan. 12 1918

● Curb Box

_____	Main	_____	Elev. of Main at tap	_____
Gate at ●		●		Gate at

● Curb Box

*Garage.*

### LABOR AND MATERIALS

Copper	} Connection	_____	\$
Lead		_____	\$
1 Curb	} Cook Valve T.S. & V.	<u>6</u> in.	\$
1 Service Box		_____	\$
Old returned	} Short $3\frac{1}{2} \times 4\frac{1}{2}$ Long $4\frac{1}{2} \times 5\frac{1}{2}$ Buff. or Rdway	_____	\$
		_____	\$
2 lengths and 2	} Copper Galv-Iron Cast Iron	_____ in.	\$
		_____	\$
Nipples	_____ in. at _____	\$	
Bushings	_____ to _____ in. at _____	\$	
Red'g Inc'g	} Couplings	_____ to _____ in. at _____	\$
		_____	\$
Union	_____ in. at _____	\$	
Meter	_____ in. at _____	\$	
Lead Joints	at _____	\$	
Leadite Joints	at _____	\$	
Hrs. Foreman	at _____	\$	
Hrs. Chauffeur	at _____	\$	
Hrs. Tapper	at _____	\$	
Hrs. Labor	at _____	\$	
Hrs. Labor	at _____	\$	
Hrs. Compressor	at _____	\$	
Compensation Ins.	_____	\$	
Trucking	_____	\$	
Builders Use of Water	_____	\$	
	<u>1- 6" cross</u>	\$	
	<u>1- 6" sleeve</u>	\$	
	<u>7- 6" lead joints</u>	\$	
	_____	\$	
	_____	\$	