

LABOR AND MATERIALS

1/	Copper	Connection	3/4		\$ 2.87
1/	Lead				
1/	Curb	Cock Valve P. S. & V.	3/4	in.	\$ 3.62
1/	Service box	Old returned { Short 3 1/2 X 4 1/2 } Long 4 1/2 X 5 1/2 } Buff or Rdway			\$ 4.68
25	Ft.		Copper		
	3 1/4	G. I.	32	Pipe at	\$ 8.00
		G. I.			
	Nipples	in. at			\$
	Bushings	to in. at			\$
	Red'g				
	Inc'g	Coupl'gs to in. at			\$
	Union	in. at			\$
	Meter	in. at			\$
	Lead Joints	at			\$
	Compound Joints	at			\$
5	Hrs. Water Maint. Man-1	at	1.12		\$ 5.60
7	Hrs. Water Maint. Man-2	at	1.02		\$ 7.14
15	Hrs. Labor	at	91		\$ 13.65
	Hrs. Labor	at			\$
	Hrs. Compressor	at			\$
	Compensation Ins.	at \$ 2.18 per C.			\$ 0.59
	Trucking				\$ 2.00
	Pav't Patch				\$
	Supply Miller				\$
	O'head				\$
					\$ 48.14

St. Pl.
Fulton 9
 Ave. No.

Name of Owner

St John

Labor and Mat'l. Report

June 27 1949

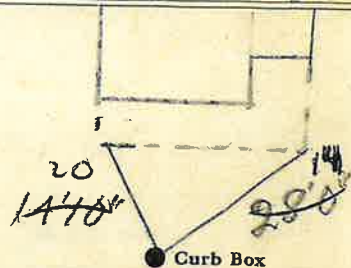

11
10 Main

Elev. of
Main at tap 5'

Gate at ●

● Gate at

● Curb Box

John Bell ✓

Labor and Materials

Copper } Connection.....	2	\$ 1.75
Lead }		
Curb { Cock }	3	\$ 1.70
{ Valve }		
{ T.S.&V. }		
Service Box { Short 3 1/2 x 4 1/4 }	2	\$ 1.45
Old returned { Long 4 1/2 x 5 1/2 }		
{ Buff. or Red wax }		
22 Ft. in. { Copper } Pipe at 13 1/2 x		\$ 7.97
{ Galv. Iron }		
{ Cast Iron }		
..... Nipples in. at		\$
..... Bushings to in. at		\$
Red'g } Couplings..... to in. at		\$
Ine'g }		
..... Union..... in. at		\$
..... Meter..... in. at		\$
..... Lbs. Br. Stone at		\$
..... Lbs. Sand at		\$
..... Bags Cement at		\$
Paving Brick { Mack } at		\$
{ Red }		
{ Asphalt }		
..... Lead Joints at		\$
..... Leadite Joints at		\$
3 Hrs. Foreman at 6 1/2 hr		\$ 1.82
3 Hrs. Common Labor at 50		\$ 1.50
3 Hrs. Common Labor at 45		\$ 1.35
..... Hrs. Mason at		\$
..... Hrs. Masons Helper at		\$
..... Hrs. Compressor at		\$
..... Compensation Ins		\$.36
..... Trucking		\$ 1.00
..... Builders Use of Water		\$ 5.00
Total \$ 23.21		

1935-169

Labor and Material Report

90 35
19

9B Fulton St Rear

Measured from No 9 for 9-B in Rear



10 Main

Elev. of Main at tap

Gate at

Gate at

Curb Box

old shot off of main this tap to be paid for Fred W. Jones

Supplies
9, 9A, 9B
(9 and 9A is the front house, 9B is the house in rear.)

hook in old pipe removed by W.P.