

LABOR AND MATERIALS

1	Copper	Connection	1"	\$	
1	Curb	Cock Valve	1" in.	\$	
1	Service box	Short 3-1/2 x 4-1/2		\$	
	Old returned	Long 4-1/2 x 5-1/2		\$	
27	Ft.	1" in.	Copper Pipe	\$	
	Nipples		in. at	\$	
	Bushings		to in. at	\$	
	Red'g			\$	
	Inc'g			\$	
	Union		in. at	\$	
	Meter		in. at	\$	
	Compound Joints		at	\$	
	Maintenance Foreman			\$	
	Hrs. Water Maint. Man - 1		at	\$	
	Hrs. Water Maint. Man - 2		at	\$	
	Hrs. Garage Foreman		at	\$	
	Hrs. Labor		at	\$	
	Hrs. Compressor		at	\$	
	Trucking			\$	
	Pav't Patch			\$	
				\$	
				\$	
				\$	
				\$	
				\$	

GLEN St. No. 453-455
 Name of Owner COLVIN

Labor and Mat'l. Report 1937, JUNE 25

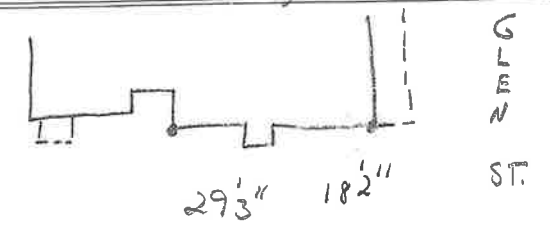

10" Main Elev. of Main at tap 5'
 Gate at CHESTER ST. Gate at

OLD TAP SHUT OFF