

LABOR AND MATERIALS

1	Copper Tread	{ Connection	3/4"		\$ 2.29
1	Curb	{ Cock Valve T.S. & V.	3/4 in.		\$ 2.70
1	Service box Old returned	{ Short 3 1/2 x 4 1/2 Long 4 1/2 x 5 1/2 Buff or Rdway			\$ 4.25
11	Ft.	3/4 in.	{ Copper C.I. C.I.	Pipe at 35	\$ 3.85
	Nipples	in. at			\$
	Bushings	to in. at			\$
	Red'g Inc'g	{ Coupl'gs	to in. at		\$
	Union	in. at			\$
	Meter	in. at			\$
	Lead Joints	at			\$
	Compound Joints	at			\$
5	Hrs. Water Maint. Man	1 at			\$
8	Hrs. Water Maint. Man	2 at	1.02		\$ 5.10
8	Hrs. Labor	at	91		\$ 7.28
	Hrs. Labor	at			\$
	Hrs. Compressor	at			\$
	Compensation Ins.	at \$		per C.	\$ 28
	Trucking				\$ 1.50
	Pay't Patch				\$ 15.75
	Tap by Moquin				\$
	O'head				\$
					\$ 42.50

Tap on lake

91-1950

✓ Glen

St. 561?
PP
Ave. No. 563

Name of Owner

Flint

Labor and Mat'l. Report

July 17 19 50

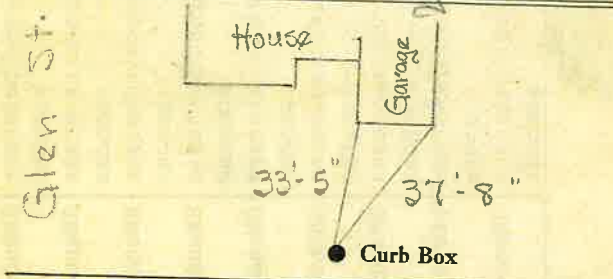

6" Main
Elev. of Main at tap 5 1/2'

Gate at ● Gate at ●

● Curb Box