

### LABOR AND MATERIALS

Used Same

Copper } Connection		\$
Lead } Connection		\$
1 Curb } Cock Valve } 3/4 in.		\$
1 Service Box } T.S. & V. }		\$
Old returned } Short 3 1/2 x 4 1/2 }		\$
	Long 4 1/2 x 6 1/2 }	\$
	Buffer Rdway }	\$
9 Ft. 3/4 in. } Copper } Pipe at		\$
	Galv. Iron }	\$
	Cast Iron }	\$
1 Nipples 3/4 in. at adapter.		\$
Bushings to in. at		\$
Red'g } Couplings to in. at		\$
Inc'g } Couplings to in. at		\$
Union in. at		\$
Meter in. at		\$
Lead Joints at		\$
Leadite Joints at		\$
Hrs. Foreman at		\$
Hrs. Chauffeur at		\$
Hrs. Tapper at		\$
Hrs. Labor at		\$
Hrs. Labor at		\$
Hrs. Compressor at		\$
Compensation Ins.		\$
Trucking		\$
Builders Use of Water		\$
This Tap Made		\$
over 14-18-52		\$
To repair Leak		\$
in service.		\$

St. \_\_\_\_\_  
Pl. \_\_\_\_\_  
Ave. No. 375

Name of Owner QUINN Gas & Service Sta.

Labor and Mat'l. Report ~~AUG 23 1939~~ 19

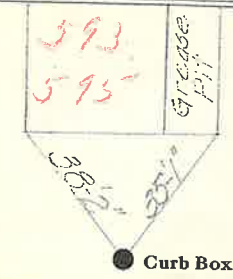

Main Elev. of Main at tap \_\_\_\_\_  
Gate at ● Gate at ●

● Curb Box  
Building Razed 1968.  
shot ass at curb  
May 29-68.