

LABOR AND MATERIALS

1	Copper	Connection	3/4"	\$
1	Lead	Cock		\$
1	Curb	Valve	3/4 in. Oriseat	\$
		T.S. & V.		\$
1	Service box	Short 3 1/2 x 4 1/2		\$
1	Old returned	Long 4 1/2 x 5 1/2		\$
		Buff or Rdway		\$
13	Ft. 3/4 in.	Copper	Pipe at	\$
		G.I.		\$
		G.I.		\$
	Nipples	in. at		\$
	Bushings	to in. at		\$
	Red'g			\$
	Inc'g	Coupl'gs to in. at		\$
	Union	in. at		\$
	Meter	in. at		\$
	Lead Joints	at		\$
	Compound Joints	at		\$
	Maintenance Foreman			\$
	Hrs. Water Maint. Man	1 at		\$
	Hrs. Water Maint. Man	2 at		\$
	Hrs. Garage Foreman	at		\$
	Hrs. Labor	at		\$
	Hrs. Compressor	at		\$
	Compensation Ins.	at \$ per C		\$
	Trucking			\$
	Pav't Patch			\$
	Tap by Kelly & Co.			\$
		9-30-63		\$
	O'head			\$

St. PL  
Ave. No. 86-90

Glen

Name of Owner  
J. E. Sawyer & Co

Labor and Mat'l. Report Sept. 30 1963

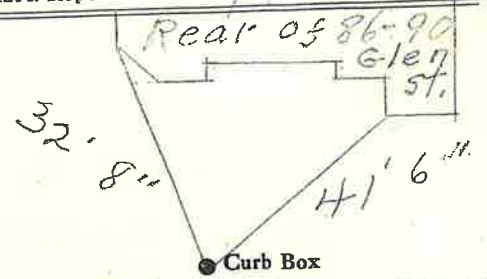

6" Tap in alley way  
Main Elev. of in rear  
Main at tap 4 1/2'

Gate at ● ● Gate at

● Curb Box  
This Tap measured  
in from rear of  
86-90 Glen St.