

**LABOR AND MATERIALS**

1	Copper	} Connection	3/4	in.	\$
	Lead				
1	Curb	} Cock Valve T.S. & V.	3/4	in.	\$
1	Service box	{ Short 3-1/2 x 4-1/2 Old returned Long 4-1/2 x 6-1/2			\$
57	Ft.	} Copper	3/4	in.	\$
	Nipples			in. at	\$
	Bushings			to in. at	\$
	Red'g				\$
	Inc'g				\$
	Union			in. at	\$
	Meter			in. at	\$
					\$
	Compound Joints at				\$
	Maintenance Foreman				\$
	Hrs. Water Maint. Man - 1 at				\$
	Hrs. Water Maint. Man - 2 at				\$
	Hrs. Garage Foreman at				\$
	Hrs. Labor at				\$
	Hrs. Compressor at				\$
					\$
	Trucking				\$
	Pav't Patch				\$
					\$
					\$
					\$
					\$

St. GLEN No. 144-46

Name of Owner BRAYLON + CHARMAN

Labor and Mat'l. Report 1925, OCT. 2

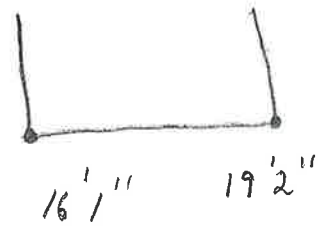

● Curb Box

**IN THE BRICKS**

10" Main Elev. of Main at tap 5'

Gate at ● Gate at ●

● Curb Box

FOR ADDITIONAL TIES  
SEE APPLICATION CARD

**CORRECT TAP CARD**

# LABOR AND MATERIALS

1 Copper } Connection \$  
 Lead }  
 1 Gurb } GATE BOX in. \$  
 Geek Valve }  
 T.S. & V. }

Service box { Short 3-1/2 x 4-1/2 } \$  
 Old returned { Long 4-1/2 x 5-1/2 } \$

71 Ft. 6 in. { Copper } Pipe at \$  
 C.I. }

Nipples \_\_\_\_\_ in. at \$  
 Bushings \_\_\_\_\_ to \_\_\_\_\_ in. at \$  
 Red'g \_\_\_\_\_  
 Inc'g \_\_\_\_\_  
 Union \_\_\_\_\_ in. at \$  
 Meter \_\_\_\_\_ in. at \$  
 \_\_\_\_\_ \$  
 Compound Joints at \$  
 Maintenance Foreman \$  
 Hrs. Water Maint. Man - 1 at \$  
 Hrs. Water Maint. Man - 2 at \$  
 Hrs. Garage Foreman \_\_\_\_\_ at \$  
 Hrs. Labor \_\_\_\_\_ at \$  
 Hrs. Compressor at \$  
 \_\_\_\_\_ \$  
 Trucking \_\_\_\_\_ \$  
 Pav't Patch \_\_\_\_\_ \$  
 \_\_\_\_\_ \$  
 \_\_\_\_\_ \$  
 \_\_\_\_\_ \$  
 \_\_\_\_\_ \$

6X10 SLEEVE + VALVE

GLEN

St. No. 144-46

Name of Owner

Labor and Mat'l. Report 1925, SEPT. 30 to OCT. 10

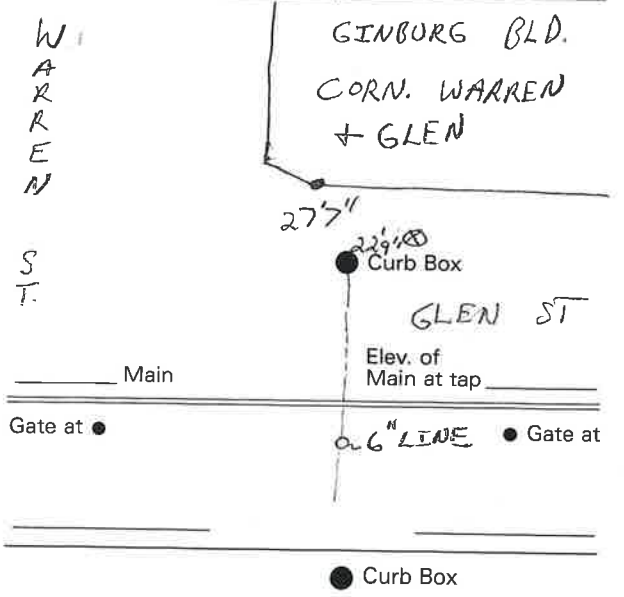

W  
A  
R  
R  
E  
N

GINBURG BLD.  
CORN. WARREN  
+ GLEN

275"

22 1/2" Curb Box

GLEN ST

Main

Elev. of Main at tap

Gate at ●

26" LINE ● Gate at

● Curb Box