

### LABOR AND MATERIALS

1	Copper	Connection	1 1/2"	\$	12.37
1	Lead				
1	Curb	Cock Valve T. S. & V.	1 1/2 in.	\$	13.45
1	Service box	Short 3 1/2 x 4 1/2	1-Ext for Box	\$	11.20
✓	Old returned	Long 4 1/2 x 5 1/2	Small	\$	
50	Ft. 1 1/2 in.	Buff or Rdway		\$	
		Copper	Pipe at .79	\$	39.50
		G.I.		\$	
		C.I.		\$	
1	Nipples	1 1/2 in. at Brass 2" long		\$	.50
	Bushings	to in. at		\$	
2	Red'g	Brass Coupl'gs 1 1/2" to 1 1/2" in. at	4.76	\$	9.52
	Ine'g			\$	
	Union	in. at		\$	
	Meter	in. at		\$	
	Lead Joints	at		\$	
	Compound Joints	at		\$	
	Hrs. Water Maint. Man-1	at		\$	
32	Hrs. Water Maint. Man-2	at 1.24		\$	39.68
10	Hrs. Labor	at 1.50		\$	15.00
77	Hrs. Labor	at 1.13		\$	87.01
10	Hrs. Compressor	at 1.50		\$	15.00
	Compensation Ins.	at \$3.706 per C.		\$	5.26
	Trucking			\$	1.00
	Pav't Patch			\$	45.64
				\$	
				\$	
	O'head			\$	
				\$	
				\$	280.33

Top made by Gifford Doreau  
5-7-52

St.  
Pl  
Ave. No. 1166-1168

Name of Owner

Glen  
Erlangers Fashion Store

Labor and Mat'l. Report

May 7 1952

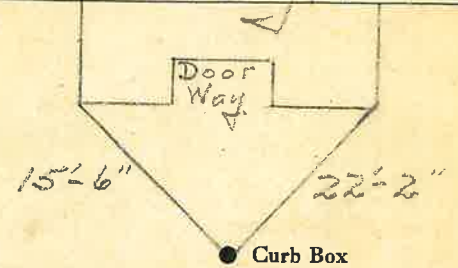

12" Main

Elev. of Main at tap 5 1/2

Gate at ●

● Gate at

● Curb Box

Old 3/4" Tap Disconnected  
at Main

# LABOR AND MATERIALS

Copper } Connection \_\_\_\_\_ \$ \_\_\_\_\_  
 Lead }  
 Curb } Cock } \_\_\_\_\_ in. \_\_\_\_\_ \$ \_\_\_\_\_  
       } Valve }  
       } T.S. & V. }  
 Service box { Short 3-1/2 x 4-1/2 } \_\_\_\_\_ \$ \_\_\_\_\_  
 Old returned { Long 4-1/2 x 5-1/2 }  
 Ft. 6 in. { Copper } Pipe at \_\_\_\_\_ \$ \_\_\_\_\_  
                   } G.I. }  
                   } C.I. }  
 Nipples \_\_\_\_\_ in. at \_\_\_\_\_ \$ \_\_\_\_\_  
 Bushings \_\_\_\_\_ to \_\_\_\_\_ in. at \_\_\_\_\_ \$ \_\_\_\_\_  
 Red'g \_\_\_\_\_  
 Inc'g \_\_\_\_\_  
 Union \_\_\_\_\_ in. at \_\_\_\_\_ \$ \_\_\_\_\_  
 Meter \_\_\_\_\_ in. at \_\_\_\_\_ \$ \_\_\_\_\_  
 \_\_\_\_\_ \$ \_\_\_\_\_  
 Compound Joints at \_\_\_\_\_ \$ \_\_\_\_\_  
 Maintenance Foreman \_\_\_\_\_ \$ \_\_\_\_\_  
 Hrs. Water Maint. Man - 1 at \_\_\_\_\_ \$ \_\_\_\_\_  
 Hrs. Water Maint. Man - 2 at \_\_\_\_\_ \$ \_\_\_\_\_  
 Hrs. Garage Foreman \_\_\_\_\_ at \_\_\_\_\_ \$ \_\_\_\_\_  
 Hrs. Labor \_\_\_\_\_ at \_\_\_\_\_ \$ \_\_\_\_\_  
 Hrs. Compressor at \_\_\_\_\_ \$ \_\_\_\_\_  
 \_\_\_\_\_ \$ \_\_\_\_\_  
 Trucking \_\_\_\_\_ \$ \_\_\_\_\_  
 Pav't Patch \_\_\_\_\_ \$ \_\_\_\_\_  
 \_\_\_\_\_ \$ \_\_\_\_\_  
 \_\_\_\_\_ \$ \_\_\_\_\_  
 \_\_\_\_\_ \$ \_\_\_\_\_  
 \_\_\_\_\_ \$ \_\_\_\_\_

GLEN

St.

~~St.~~ No. 166-168

Name of Owner

Labor and Mat'l. Report 19 29, APR. 27



62'0"    63'10"

● Curb Box  
GATE

12" Main

Elev. of Main at tap 4 1/2'

Gate at ●

● Gate at

● Curb Box

SPRINKLER TAP