

LABOR AND MATERIALS

Copper } Connection _____ \$
 Lead }
 Curb } Cock _____ in. \$
 Valve }
 T.S. & V. }
 Service box { Short 3-1/2 x 4-1/2 } _____ \$
 Old returned { Long 4-1/2 x 5-1/2 }
 Ft. _____ in. { Copper } Pipe at _____ \$
 { G.I. }
 { C.I. }
 Nipples _____ in. at _____ \$
 Bushings _____ to _____ in. at _____ \$
 Red'g _____
 Inc'g _____
 Union _____ in. at _____ \$
 Meter _____ in. at _____ \$
 _____ \$
 Compound Joints at _____ \$
 Maintenance Foreman _____ \$
 Hrs. Water Maint. Man - 1 at _____ \$
 Hrs. Water Maint. Man - 2 at _____ \$
 Hrs. Garage Foreman _____ at _____ \$
 Hrs. Labor _____ at _____ \$
 Hrs. Compressor at _____ \$
 _____ \$
 Trucking _____ \$
 Pav't Patch _____ \$
 _____ \$
 _____ \$
 _____ \$
 _____ \$
 _____ \$

GLEN

St. BETWEEN
 Ave. No. 294-300

Name of Owner

Labor and Mat'l. Report 19 14

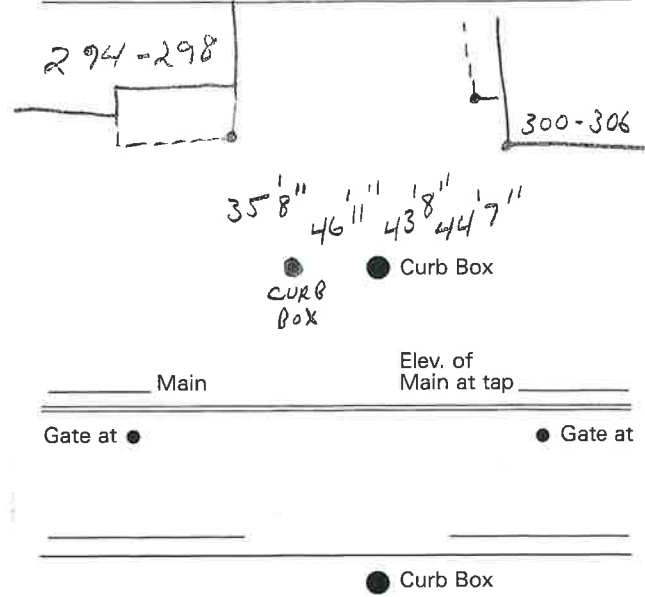

_____ Main
 Elev. of Main at tap _____
 Gate at ● Gate at ●

 ● Curb Box