

**Labor and Materials**

Copper	Lead	Connection	.....	\$	
Curb	Cock Valve	T. S. & V.	..... in.	\$	
			.....	\$	
Service Box	Short 3	x 4 1/2	} Pipe at	\$	
Old returned	Long 4	x 5 1/2			
5.7 Ft.	2	in.	Copper Galv. Iron Cast Iron	57.30	✓
Nipples	.....	in. at	.....	\$	
Bushings	.....	to in. at	.....	\$	
2	Red's	Couplings	..... to in. at	\$	12.62 ✓
2	Union	2	in. at	\$	7.26 ✓
Meter	.....	in. at	.....	\$	
Lbs. Br. Stone	at	.....	.....	\$	
Lbs. Sand	at	.....	.....	\$	
Bags Cement	at	.....	.....	\$	
Paving Brick	Mack Red Asphalt	} at	.....	\$	
Lead Joints			at	.....	\$
Leadite Joints	at	.....	.....	\$	
4	Hrs. Foreman	at	.....	\$	2.50
4	Hrs. Common Labor	at	.....	\$	2.-
Hrs. Common Labor	at	.....	.....	\$	
Hrs. Mason	at	.....	.....	\$	
Hrs. Mason's Helper	at	.....	.....	\$	
Hrs. Compressor	at	.....	.....	\$	
Compensation Ins.	.....	.....	.....	\$	.13
Trucking	.....	.....	.....	\$	
Builders' Use of Water	.....	.....	.....	\$	
Total				\$	75.81

**240° Glen St**

Labor and Material Report 19 1926

2" pipe from curb box into new church Notre Dame Calher st

(over) 396-410

● Curb Box

---

Main	Elev. of Main at tap
Gate at ●	● Gate at

● Curb Box

This Tap must be on Glen St.  
57' - 2" K-Cop.

This tap must be on Glen St  
57' - 2" K-Cop.

## LABOR AND MATERIALS

1	Copper Lead	} Connection	2"		\$
1	Curb	} Cock Valve T. S. & V.	2	in.	\$
1	Service Box Old returned	} Short 3 1/2 x 4 1/2 Long 4 1/2 x 5 1/2 Buff for Rdway			\$
8	Ft.	2	in.	} Copper Galv Iron Cast Iron	Pipe at \$
	Nipples				in. at \$
	Bushings				to in. at \$
	Red'g Inc'g	} Couplings			to in. at \$
	Union				in. at \$
	Meter				in. at \$
	Lead Joints				at \$
	Leadite Joints				at \$
	Hrs. Foreman				at \$
	Hrs. Chauffeur				at \$
	Hrs. Tapper				at \$
	Hrs. Labor				at \$
	Hrs. Labor				at \$
	Hrs. Compressor				at \$
	Compensation Ins.				\$
	Trucking				\$
	Builders Use of Water				\$
					\$
					\$
					\$
					\$
					\$
					\$

396-410

St.  
Pl.  
Ave. No. 240

Name of Owner  
Presbyterian Church

Nov 19

Labor and Mat'l. Report AUG 23 1939 19 20

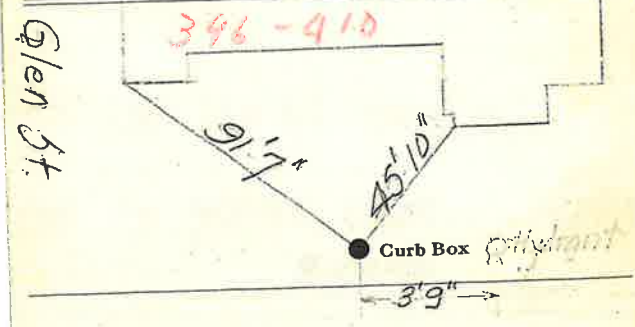

Elev. of  
Main at tap.....

Gate at ● 51. ● Gate at

● Curb Box