

LABOR AND MATERIALS

1	Copper	Connection	3/4	\$	
1	Curb	Cock Valve T.S. & V.	3/4 in.	\$	
1	Service box	Short 3-1/2 x 4-1/2- Old returned Long 4-1/2 x 5-1/2		\$	
10	Ft.	3/4 in. Copper	Pipe at	\$	
	Nipples		in. at	\$	
	Bushings		to in. at	\$	
	Red'g			\$	
	Inc'g			\$	
	Union		in. at	\$	
	Meter		in. at	\$	
				\$	
	Compound Joints at			\$	
	Maintenance Foreman			\$	
	Hrs. Water Maint. Man - 1 at			\$	
	Hrs. Water Maint. Man - 2 at			\$	
	Hrs. Garage Foreman		at	\$	
	Hrs. Labor		at	\$	
	Hrs. Compressor at			\$	
				\$	
	Trucking			\$	
	Pav't Patch			\$	
				\$	
				\$	
				\$	
				\$	
				\$	
				\$	
				\$	

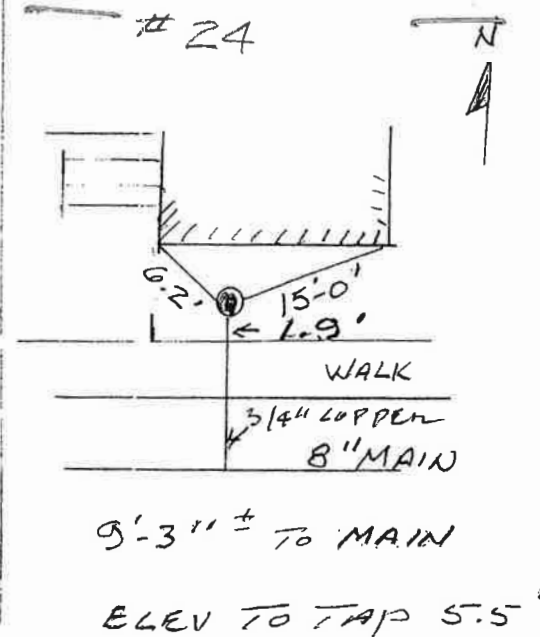

9'-3" ± TO MAIN
ELEV TO TAP 5.5'

SEPT 2006

TAX ID # 302.20-6-30