

LABOR AND MATERIALS

1	Copper head	Connection	3/4"		\$ 2.79
1	Curb	Cock Valve P.S. & V.	3/4" in.		\$ 2.70
1	Service box Old returned	Short 3 1/2 x 4 1/2 Long 4 1/2 x 5 1/2 Buff or Rdway			\$ 4.25
8	Ft. 3/4 in.	Copper C.I. C.I.	Pipe at 35		\$ 2.80
	Nipples	in. at			\$
	Bushings	to in. at			\$
	Red'g Inc'g	Coupl'gs to in. at			\$
	Union	in. at			\$
	Meter	in. at			\$
	Lead Joints at				\$
	Compound Joints at				\$
	Hrs. Water Maint. Man-1 at				\$
3	Hrs. Water Maint. Man-2 at	1.02			\$ 3.06
14	Hrs. Labor	at 91			\$ 12.74
	Hrs. Labor	at			\$
	Hrs. Compressor at				\$
	Compensation Ins. at \$	per C.			\$ 35
	Trucking				\$ 1.00
	Pav't Patch	B.P.			\$
	O'head				\$
					\$ 29.19

116-1950

Before Paving

Grand

St. 9
Ave. No. 9

Name of Owner

Helen M. Albert

Labor and Mat'l. Report

July 5 1950

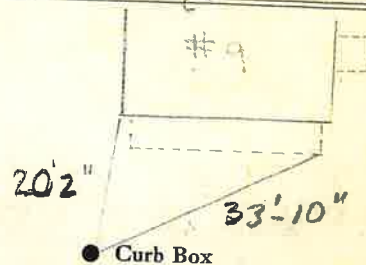

4" Main

Elev. of
Main at tap 5'

Gate at ●

● Gate at

● Curb Box

Remeasured 2-14-77