

LABOR AND MATERIALS

1	Copper } Connection	3/4	\$
1	Curb } Cock Valve } I.G. & V. }	3/4 in.	\$
1	Service box } Old returned }	{ Short 3-1/2 x 4-1/2 } { Long 4-1/2 x 5-1/2 }	\$
22	Ft. 3/4 in. } (used) }	{ Copper } { Gal. } { Gal. }	Pipe at \$
	Nipples	in. at	\$
	Bushings	to in. at	\$
	Red'g		
	Inc'g		
	Union	in. at	\$
	Meter	in. at	\$
			\$
	Compound Joints at		\$
	Maintenance Foreman		\$
	Hrs. Water Maint. Man - 1 at		\$
	Hrs. Water Maint. Man - 2 at		\$
	Hrs. Garage Foreman	at	\$
	Hrs. Labor	at	\$
	Hrs. Compressor at		\$
			\$
	Trucking		\$
	Pav't Patch		\$
			\$
			\$
			\$
			\$
			\$

CORANT

St. 8
Pl. 8
Ave. No. 8

Name of Owner _____
TAX ID 302.16-9-8

Labor and Mat'l. Report 1935, Oct. 2

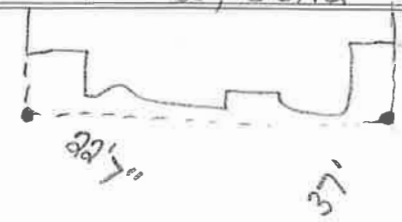

● Curb Box

4 Main

Elev. of Main at tap 4 1/2

Gate at ●

● Gate at

● Curb Box

OLD TAP SHUT OFF AT MAIN