

LABOR AND MATERIALS

1	Copper	Connection	3/4	\$	_____
1	Curb	Cock Valve	3/4 in.	\$	_____
1	Service box	Short 3-1/2 x 4-1/2		\$	_____
	Old returned	Long 4-1/2 x 5-1/2		\$	_____
24	Ft.	Copper	3/4 in.	Pipe at	\$ _____
_____	Nipples	_____	in.	at	\$ _____
_____	Bushings	_____	to	_____	in. at \$ _____
_____	Red'g				
_____	Inc'g				
_____	Union	_____	in.	at	\$ _____
_____	Meter	_____	in.	at	\$ _____
_____	Compound Joints	at			\$ _____
_____	Maintenance Foreman				\$ _____
_____	Hrs. Water Maint. Man - 1	at			\$ _____
_____	Hrs. Water Maint. Man - 2	at			\$ _____
_____	Hrs. Garage Foreman	at			\$ _____
_____	Hrs. Labor	at			\$ _____
_____	Hrs. Compressor	at			\$ _____
_____	Trucking				\$ _____
_____	Pav't Patch				\$ _____
_____					\$ _____
_____					\$ _____
_____					\$ _____
_____					\$ _____
_____					\$ _____

GRANT Ave. No. 73
 Name of Owner _____
 Labor and Mat'l. Report 19 30, OCT. 24

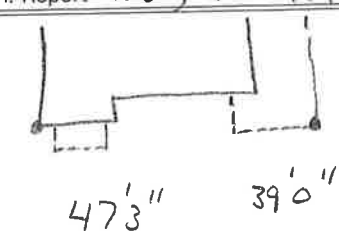

6" Main Elev. of Main at tap 5'
 Gate at ● Gate at ●
 ● Curb Box

OUT SIDE CLEAN OUT NEAR
 H₂O SHUT OFF.