

# LABOR AND MATERIALS

1	Copper } Connection	3/4	\$
1	Curb } Cock	3/4 in.	\$
1	Service box { Short 3-1/2 x 4-1/2 Old returned { Long 4-1/2 x 5-1/2 }		\$
11	Ft. 3/4 in. { Copper } Pipe at		\$
	Nipples	in. at	\$
	Bushings	to in. at	\$
	Red'g		
	Inc'g		
	Union	in. at	\$
	Meter	in. at	\$
			\$
	Compound Joints at		\$
	Maintenance Foreman		\$
	Hrs. Water Maint. Man - 1 at		\$
	Hrs. Water Maint. Man - 2 at		\$
	Hrs. Garage Foreman	at	\$
	Hrs. Labor	at	\$
	Hrs. Compressor at		\$
			\$
	Trucking		\$
	Pav't Patch		\$
			\$
			\$
			\$
			\$
			\$

GRANT

Ave. No. 80

Name of Owner

Labor and Mat'l. Report 19 31, JUNE 1

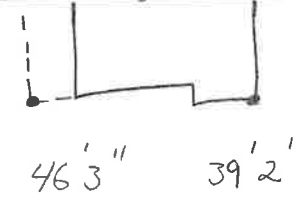

● Curb Box

6" Main

Elev. of Main at tap 5'

Gate at ●

● Gate at

● Curb Box

NEW HOUSE