

LABOR AND MATERIALS

1	Copper } Connection	3/4"		\$	
	Lead				
1	Curb } Cock	3/4" in.		\$	
	} Valve				
	} T.S. & V.				
1	Service box	{ Short 3-1/2 x 4-1/2		\$	
	Old returned	{ Long 4-1/2 x 5-1/2			
25	Ft. 3/4" in. { Copper			\$	
		} Pipe at			
	Nipples	in. at		\$	
	Bushings	to in. at		\$	
	Red'g				
	Inc'g				
	Union	in. at		\$	
	Meter	in. at		\$	
				\$	
	Compound Joints at			\$	
	Maintenance Foreman			\$	
	Hrs. Water Maint. Man - 1 at			\$	
	Hrs. Water Maint. Man - 2 at			\$	
	Hrs. Garage Foreman at			\$	
	Hrs. Labor at			\$	
	Hrs. Compressor at			\$	
				\$	
	Trucking			\$	
	Pav't Patch			\$	
				\$	
				\$	
				\$	
				\$	
				\$	

REAR OF PROPERTY

12 1/2' or

GRANT

P. E.

Ave. No.

14 1/2'

Name of Owner

Labor and Mat'l. Report 1935 Oct 2

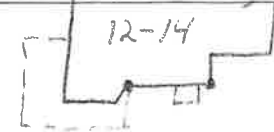

4 1/6" 29 1/9"

● Curb Box

4" Main

Elev. of Main at tap 4 1/2'

Gate at ●

● Gate at

● Curb Box

OLD TAP SHUT OFF AT MAIN

NOTE: THIS TAP IS MEASURED FROM 12-14 GRANT AVE.

4/13/00

