

LABOR AND MATERIALS

1	Copper Lead	Connection	3/4"	\$	3.08
1	Curb	Cock Valve T.S. & V.	3/4 in.	\$	2.99
1	Service box Old returned	Short 3 1/2 x 4 1/2 Long 4 1/2 x 5 1/2 Buff or Rdway		\$	4.32
39	Ft. 3/4 in.	Copper G.I. Pipe at	4/5	\$	17.55
	Nipples	in. at		\$	
	Bushings	to in. at		\$	
	Red'g Inc'g	Coupl'gs to in. at		\$	
	Union	ip. at		\$	
	Meter	in. at		\$	
	Lead Joints	at		\$	
	Compound Joints	at		\$	
	Maintenance Foreman			\$	5.76
	Hrs. Water Maint. Man-1	at		\$	
9 1/2	Hrs. Water Maint. Man-2	at	1.613	\$	15.32
7 1/2	Hrs. Garage Foreman	at	2.033	\$	15.25
15 1/2	Hrs. Labor	at	1.30	\$	20.15
3	Hrs. Compressor	at	1.481	\$	4.44
	Compensation Ins. at	\$ 56.86 per C		\$	3.14
	Trucking			\$	1.50
	Pay't Patch			\$	
	Tap by Gifford + Rosmer			\$	
	O'head			\$	
				\$	88.64

8164

Grant (Ext.) St. No. 118

Name of Owner Lawrence Sheehan

Labor and Mat'l. Report Nov. 28 19 56

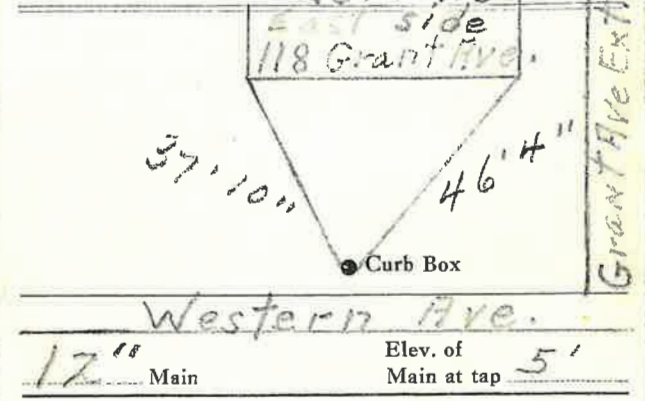

Gate at • Gate at

QUEENSBURY TAX ID # 302.19-1-7

• Curb Box
This Tap on Western Ave.

4-11-00
Chd. - dye tested -
connected to City
sewer system