

LABOR AND MATERIALS

Copper	}	Connection		\$		
Lead						
Curb	}	Cock	in.	\$		
		Valve				
		T. S. & V.				
Service box	}	Short 3½ x 4½		\$		
Old returned		Long 4½ x 5½				
		Buff or Rdway				
Ft.	}	Copper	Pipe at	\$		
in.		G. I.				
		C. I.				
Nipples	in.	at		\$		
Bushings	to	in.	at	\$		
Red'g	}	Coupl'gs	to	in.	at	\$
Inc'g						
Union	in.	at		\$		
Meter	in.	at		\$		
Lead Joints	at			\$		
Compound Joints	at			\$		
Maintenance Foreman				\$		
Hrs. Water Maint. Man—1	at			\$		
Hrs. Water Maint. Man—2	at			\$		
Hrs. Garage Foreman	at			\$		
Hrs. Labor—	at			\$		
Hrs. Compressor	at			\$		
Compensation Ins.	at \$	per C		\$		
Trucking				\$		
Pav't Patch				\$		
				\$		
				\$		
				\$		
O'head				\$		
				\$		

St. _____
Pl: _____
Ave. No. 22

Graves
Name of Owner

Labor and Mat'l. Report 19

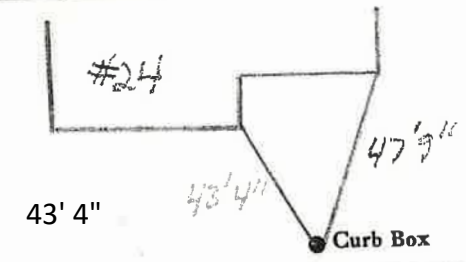

Main Elev. of Main at tap

Gate at ● ● Gate at

● Curb Box

Note - Curb Box for 22 Graves is in #24's driveway

Note: Curb Box for 22 Graves is in #24's driveway.

LABOR AND MATERIALS

1	Brass Copper Lead	Connection	1" x 3/4" (T)	\$
1	Curb	Cock Valve T.S. & V.	3/4 in. Oriseal	\$
1	Service box Old returned	Short 3 1/2 x 4 1/2 Long 4 1/2 x 5 1/2 Buff or Rdway		\$
11	Ft. 3/4 in.	Copper G.I. C.I.	Pipe at	\$
	Nipples	in. at		\$
	Bushings	to in. at		\$
	Red'g } Inc'g }	Coupl'gs	to in. at	\$
	Union	in. at		\$
	Meter	in. at		\$
	Lead Joints at			\$
	Compound Joints at			\$
	Maintenance Foreman			\$
	Hrs. Water Maint. Man-1 at			\$
	Hrs. Water Maint. Man-2 at			\$
	Hrs. Garage Foreman	at		\$
	Hrs. Labor	at		\$
	Hrs. Compressor at			\$
	Compensation Ins. at \$	per C		\$
	Trucking			\$
	Pav't Patch			\$
	Tap by Gifford & Co.			\$
	9-20-67.			\$
	O'head			\$
				\$

St. Graves
Pl. 22
Ave. No. 22

Name of Owner Henry Riley

Labor and Mat'l. Report Sept. 20 1967

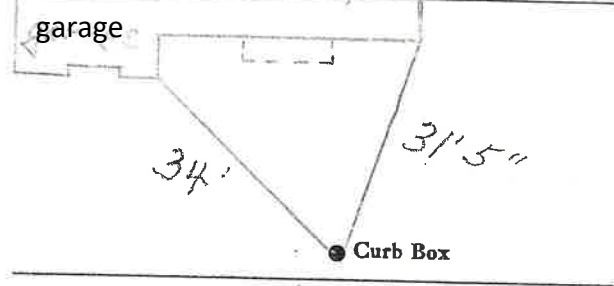

1" Main Elev. of Main at tap 5'

Gate at ● Gate at ●

● Curb Box