

LABOR AND MATERIALS

1	Copper Lead	Connection	3/4		\$ 1.78	
1	Curb	Clock Valve T.S. & V.	3/4	in.	\$ 2.61	
1					Service box Old returned	Short 3 1/4 X 4 1/4 Long 4 1/4 X 5 1/4 Buff or Rdway
3.1	Ft.	3/4	in.	Copper Galv. Iron Cast Iron		
	Nipples	in.	at		\$	
	Bushings	to	in.	at	\$	
	Red'g Inc'g	Couplings	to	in.	at	\$
			Union	in.	at	\$
	Meter	in.	at	\$		
	Lead Joints	at	\$			
	Compound Joints	at	\$			
	Hrs. Foreman	at	\$			
	Hrs. Chauffeur	at	\$			
	Hrs. Tapper	at	\$			
	Hrs. Labor	at	\$			
	Hrs. Labor	at	\$			
	Hrs. Compressor	at	\$			
	Compensation Ins.		\$			
	Trucking		\$			
	Builders Use of Water		\$			
	<i>Tap by Warschick</i>					
					\$	
					\$	
					\$	
					\$	

55-46

V

St. 46 S
Pl. 322
Ave. No.

Glen St

Name of Owner Stub to Curb, Fitzgerald

Labor and Mat'l. Report Apr. 10 1946

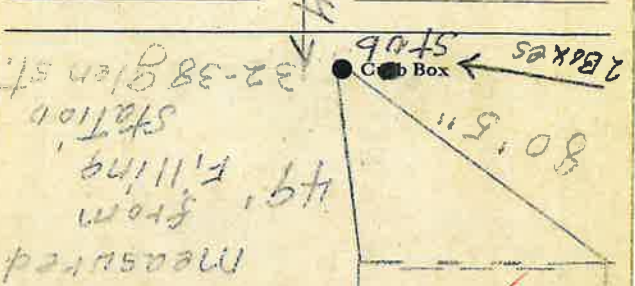
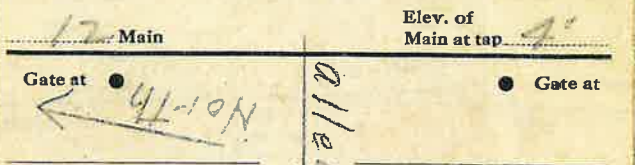
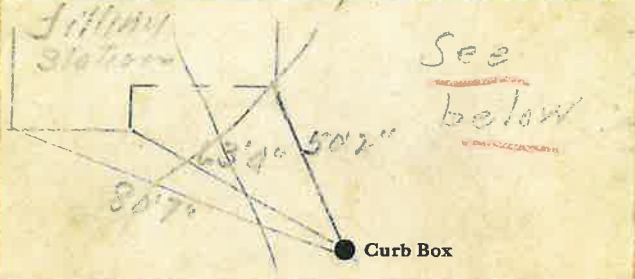

LSM-5C-6-1-46 *Take Charge* ✓

