



### LABOR AND MATERIALS

1	Copper	Connection	1"		\$ 2.79	
1	Curb	Clock Valve	1"	in.	\$ 3.60	
1	Service box	} Short 3" X 4" Long 4" X 5" Buff for Rdway			\$ 1.82	
	Old returned					
3	Ft.	Copper	} Pipe at 23¢	1.15		
	in.	Galv. Iron		Cast Iron		
	Nipples	in.	at		\$	
	Bushings	to	in.	at	\$	
	Red'g Inc'g	} Couplings	to	in.	at	\$
	Union		in.	at		\$
	Meter	in.	at		\$	
	Lead Joints	at			\$	
	Compound Joints	at			\$	
5	Hrs.	Foreman at WWM	84		\$ 4.20	
7	Hrs.	Chauffeur at	75		\$ 5.25	
	Hrs.	Tapper at			\$	
22	Hrs.	Labor at	65		\$ 14.30	
	Hrs.	Labor at			\$	
1	Hrs.	Compressor at	87 1/2		\$ 88	
	Compensation	Ins.			\$ 65	
	Trucking				\$ 1.00	
	Builders Use of Water	Patch 2			\$ 9.00	
	Tap by Warski				\$	
	Old taps on Glen St to be dug up				\$ 44.64	

12-46

Glen

St. 64-68  
Pl.  
Ave. No. 44

Name of Owner

Sawyer Co

Labor and Mat'l. Report April 11 1946

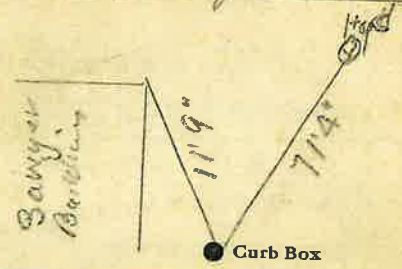

6

Main

Elev. of Main at tap 5-

Gate at ●

● Gate at

● Curb Box

### LABOR AND MATERIALS

Copper	}	Connection	-----	\$
Lead			-----	\$
Curb	}	Cock Valve T. S. & V.	----- in.	\$
Service Box			-----	\$
Old returned	}	Short 3 1/2 x 4 1/2	} Pipe at	\$
		Long 4 1/2 x 5 1/2		
		Buff. or Rdway		
Ft. ----- in.	}	Copper	} Pipe at	\$
		Galv Iron		
		Cast Iron		
Nipples	in. at	-----	\$	
Bushings	to ----- in. at	-----	\$	
Red'g Inc'g	}	Couplings	to ----- in. at	\$
Union			in. at	-----
Meter	in. at	-----	\$	
Lead Joints	at	-----	\$	
Leadite Joints	at	-----	\$	
Hrs. Foreman	at	-----	\$	
Hrs. Chauffeur	at	-----	\$	
Hrs. Tapper	at	-----	\$	
Hrs. Labor	at	-----	\$	
Hrs. Labor	at	-----	\$	
Hrs. Compressor	at	-----	\$	
Compensation Ins.	-----	\$		
Trucking	-----	\$		
Builders Use of Water	-----	\$		
	-----	\$		
	-----	\$		
	-----	\$		
	-----	\$		
	-----	\$		

St. 69-68  
~~Pl.~~  
 Ave. No. 44-48

Glen

---

Name of Owner  
J.E. Sawyer & Co.

---

Labor and Mat'l. Report SEP 13 1940 19

---

DISCONTINUED  
 10/20/41

69-68

---

Main Glen St. Elev. of Main at tap \_\_\_\_\_

Gate at ● ● Gate at

---

New tap for front of Building

---

● Curb Box

See attached paper for MEAS. 10/20/41

This tap is on Glen St. Hill, near the south end of Sawyer Bldg.