

### LABOR AND MATERIALS

1	Copper	Lead	Connection	1/2"	\$	
1	Curb	Cock Valve T.S. & V.	3/4 in.	\$		
1	Service box	Old returned	Short 3-1/2 x 4-1/2 Long 4-1/2 x 5-1/2	\$		
8	Ft.	3/4 in.	Copper G.I. Pipe	at	\$	
	Nipples		in.	at	\$	
	Bushings		to	in.	at	\$
	Red'g					
	Inc'g					
	Union		in.	at	\$	
	Meter		in.	at	\$	
	Compound Joints	at		\$		
	Maintenance Foreman			\$		
	Hrs. Water Maint. Man - 1	at		\$		
	Hrs. Water Maint. Man - 2	at		\$		
	Hrs. Garage Foreman	at		\$		
	Hrs. Labor	at		\$		
	Hrs. Compressor	at		\$		
	Trucking			\$		
	Pav't Patch			\$		
	pavement			\$		

Glen St. Ave. No. 509  
Name of Owner

Labor and Mat'l. Report 1923, May 3

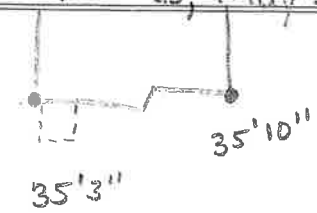

● Curb Box

12" Main Elev. of Main at tap 4 1/2

Gate at ● Gate at ●

● Curb Box

1/2" Tap at 507 Glen St.