

LABOR AND MATERIALS

Copper	{ Connection	1" in.	\$		
Lead					
Curb	{ Cock Valve	1" in.	\$	5.19	
	{ T.S. & V.				
Service box	{ Short 3 1/2 x 4 1/2		\$	4.25	
Old returned	{ Long 4 1/2 x 5 1/2				
	{ Buff or Rdway				
12 Ft. 1" in.	{ Copper	Pipe at 40	\$	4.80	
	{ G.I.				
	{ C.I.				
Nipples	in. at		\$		
Bushings	to in. at		\$		
Red'g	{ Coupl'gs	to in. at	\$		
Inc'g					
Union	in. at		\$		
Meter	in. at		\$		
Lead Joints at			\$		
Compound Joints at			\$		
Hrs. Water Maint. Man-1 at			\$		
Hrs. Water Maint. Man-2 at	1.02		\$	15.30	
Hrs. Labor & Mat.	1.14		\$	1.14	
Hrs. Labor at	91		\$	30.03	
Hrs. Compressor at	1.20		\$	2.40	
Compensation Ins. at \$ 2.22	per C.		\$	1.03	
Trucking			\$	1.10	
Pav't Patch			\$	15.12	
<i>Top by 1897 main</i>					
O'head			\$		

9-19-50

Glen

St. _____
 Pl. _____
 Ave. No. *183185*

Name of Owner
Hayes Est

Labor and Mat'l. Report *Jan 12* 19*50*

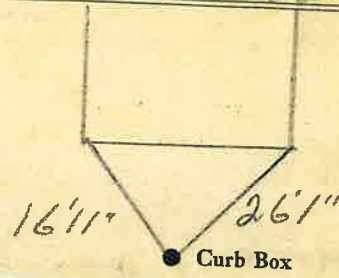

12 Main Elev. of Main at tap *5 1/2*

Gate at ● Gate at ●

● Curb Box



LSM-5C 10-21-49

To be Billed

59.12

LABOR AND MATERIALS

1 Copper } Connection 12" 6" Tapping \$
 Lead } sleeve
 1 Curb } Cock } 6 in. Tapping Valve \$
 Valve }
 T. S. & V. }
 1 Service box } Short 3 1/2 x 4 1/2 }
 Old returned } Long 4 1/2 x 5 1/2 } \$
 } Buff or Rdway }
 Ft. in. } Copper } Pipe at \$
 } G. I. }
 } C. I. }
 Nipples in. at \$
 Bushings to in. at \$
 Red'g }
 Inc'g } Coupl'gs to in. at \$
 Union in. at \$
 Meter in. at \$
 Lead Joints at \$
 Compound Joints at \$
 Maintenance Foreman \$
 Hrs. Water Maint. Man-1 at \$
 Hrs. Water Maint. Man-2 at \$
 Hrs. Garage Foreman at \$
 Hrs. Labor at \$
 Hrs. Compressor at \$
 Compensation Ins. at \$ per C. \$
 Trucking \$
 Pav't Patch \$
 Tap by Larson Co. \$
10-26-67. \$
 O'head \$

Note:-
 1-2'-Piece 6" C.I. M.J
 Pipe Furnished by Dept.
 Balance by Contractor.

St. Glen
 Pl. 183
 Ave. No. 183

Name of Owner
Gorman Shoe Inc.

Labor and Mat'l. Report Oct. 26 1967

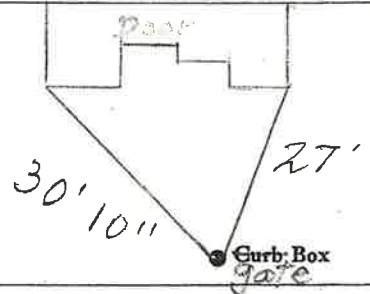

12" Main Elev. of Main at tap 5'
 Gate at • Gate at

• Curb Box
 6" Tap for Sprinkler System.

LABOR AND MATERIALS

1 Copper } Connection 12" x 6" Tapping
 Lead } sleeves. \$

1 Curb } Cock } 6 in. Tapping Valve
 Valve } \$
 T. S. & V. }

1 Service box { Short 3 1/2 x 4 1/2 }
 Old returned { Long 4 1/2 x 5 1/2 }
 Buff or Rdway } \$

Ft. in. { Copper } Pipe at \$
 { C. I. }

Nipples in. at \$

Bushings to in. at \$

Red'g }
 Inc'g } Coupl'gs to in. at \$

Union in. at \$

Meter in. at \$

Lead Joints at \$

Compound Joints at \$

Maintenance Foreman \$

Hrs. Water Maint. Man-1 at \$

Hrs. Water Maint. Man-2 at \$

Hrs. Garage Foreman at \$

Hrs. Labor at \$

Hrs. Compressor at \$

Compensation Ins. at \$ per C \$

Trucking \$

Pav't Patch \$

Tap by Larcourt & Co. \$

10-26-67. \$

O'head \$

Note:-
 1-2'-Piece 6" C.I.M.J
 Pipe Furnished by Dept.
 Balance by Contractor.

Glen St. Ave. No. 183

Name of Owner
 Gorman Shoe Inc.

Labor and Mat'l. Report Oct. 26 1967

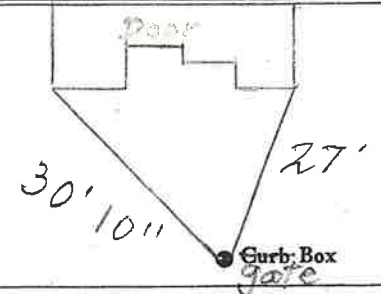

12" Main Elev. of Main at tap 5'
 Gate at • Gate at •

• Curb Box
 6" Tap for Sprinkler System.