

### LABOR AND MATERIALS

Copper	Lead	Connection		\$
1	Curb	Cock Valve T. S. & V.	2 in.	\$
1	Service box Old returned	Short 3 1/2 x 4 1/2 Long 4 1/2 x 5 1/2 Buff or Rdway		\$
11	Ft. 2 in.	Copper G. I. C. I.	Pipe at	\$
	Nipples	in. at		\$
	Bushings	to in. at		\$
	Red'g Inc'g	Coupl'gs	to in. at	\$
	Union	in. at		\$
	Meter	in. at		\$
	Lead Joints	at		\$
	Compound Joints	at		\$
	Maintenance Foreman			\$
	Hrs. Water Maint. Man	1 at		\$
	Hrs. Water Maint. Man	2 at		\$
	Hrs. Garage Foreman	at		\$
	Hrs. Labor	at		\$
	Hrs. Compressor	at		\$
	Compensation Ins.	at \$ per C		\$
	Trucking			\$
	Pav't Patch			\$
				\$
				\$
	O'head			\$
				\$

St. 237  
 Ave. No. 237

Name of Owner  
First National Bank

Labor and Mat'l. Report Aug. 30 1949

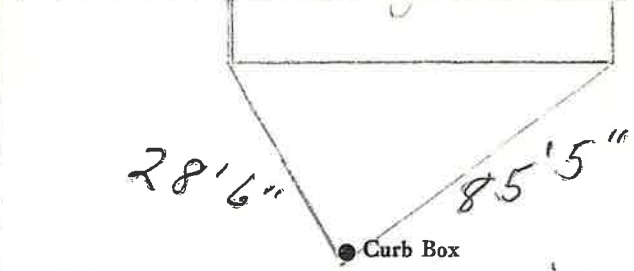

galv. Lapham PL. Side  
 3" Main Elev. of Main at tap 5 1/2'

Gate at ● Gate at ●

\_\_\_\_\_

\_\_\_\_\_

● Curb Box

LABOR AND MATERIALS

1	Copper	} Connection	2"	\$
	Lead			
1	Curb	} Cock Valve T.S. & V.	2 in.	\$
1	Service box	} Short 3 1/2 x 4 1/2 Long 4 1/2 x 5 1/2 Buff or Rdway		\$
	Old returned			
3	Ft. 2 in.	} Copper G.I. C.I.	Pipe at	\$
	Nipples	in. at		\$
	Bushings	to in. at		\$
	Red'g Inc'g	} Coupl'gs	to in. at	\$
	Union	in. at		\$
	Meter	in. at		\$
	Lead Joints	at		\$
	Compound Joints	at		\$
	Maintenance Foreman			\$
	Hrs. Water Maint. Man	—1 at		\$
	Hrs. Water Maint. Man	—2 at		\$
	Hrs. Garage Foreman	at		\$
	Hrs. Labor	at		\$
	Hrs. Compressor	at		\$
	Compensation Ins.	at \$ per C		\$
	Trucking			\$
	Pav't Patch			\$
	Measured in by Miller & Kelly			\$
	5-6-62			\$
	O'head			\$

INSTALLED - 1927

Glen St. Pl. No. 237 Ave. No. 237

Name of Owner

First National Bank

measured in Labor and Mat'l. Report May 1962

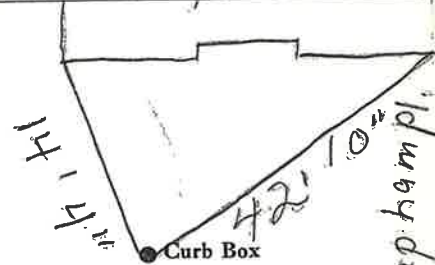

Glen St.

12 Main

Elev. of Main at tap 4-5'

Gate at •

• Gate at

• Curb Box

Box Covered with Cement.