

LABOR AND MATERIALS

Copper	}	Connection		\$	
Lead					
Curb	}	Cock		\$	
		Valve			
		T.S. & V.			
Service box	{	Short 3-1/2 x 4-1/2		\$	
Old returned		Long 4-1/2 x 5-1/2			
Ft. _____ in.	{	Copper		\$	
		G.I.			
		C.I.			
Nipples		in. at		\$	
Bushings		to _____ in. at		\$	
Red'g				\$	
Inc'g				\$	
Union		in. at		\$	
Meter		in. at		\$	
				\$	
Compound Joints at				\$	
Maintenance Foreman				\$	
Hrs. Water Maint. Man - 1 at				\$	
Hrs. Water Maint. Man - 2 at				\$	
Hrs. Garage Foreman		at		\$	
Hrs. Labor		at		\$	
Hrs. Compressor at				\$	
				\$	
Trucking				\$	
Pav't Patch				\$	
				\$	
				\$	
				\$	
				\$	

LINE IS 2" INSIDE

GLENNS FALLS

TECHNICAL PARK

St.

Ave. No.

8

Name of Owner

BOSTON SCIENTIFIC / R. JENNINGS ^{OLD}

Labor and Mat'l. Report

MAY 2004

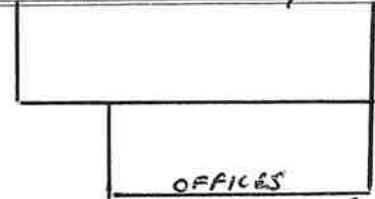

_____ Main

Elev. of
Main at tap _____

Gate at ●

TECHNICAL PARK

● Gate at

● Curb Box

A = 77'

B = 98'5"