

Gate at ● Gate at ●  
Main 4" Main 4"  
Elev. of Main at tap 4' Elev. of Main at tap 4'

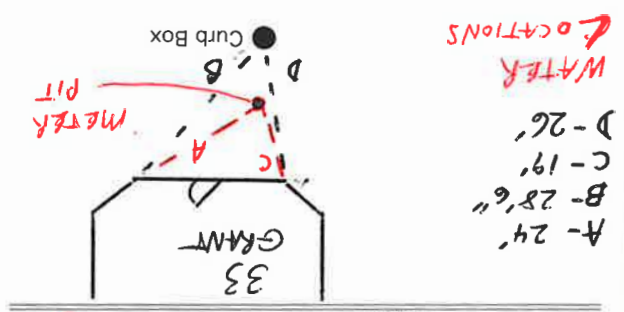

Gate at ● Gate at ●  
Main 4" Main 4"  
Elev. of Main at tap 4' Elev. of Main at tap 4'

Name of Owner GRANT  
St. Pl. Ave. No. 33

Labor and Mat'l. Report MARCH 2003

GRANT St. Pl. Ave. No. 33

Name of Owner  
TAX ID # 302.19-11-17

Labor and Mat'l. Report MARCH 2003

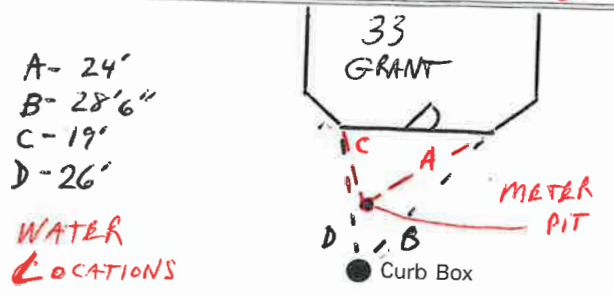

Gate at ● Gate at ●  
Main 4" Main 4"  
Elev. of Main at tap 4' Elev. of Main at tap 4'

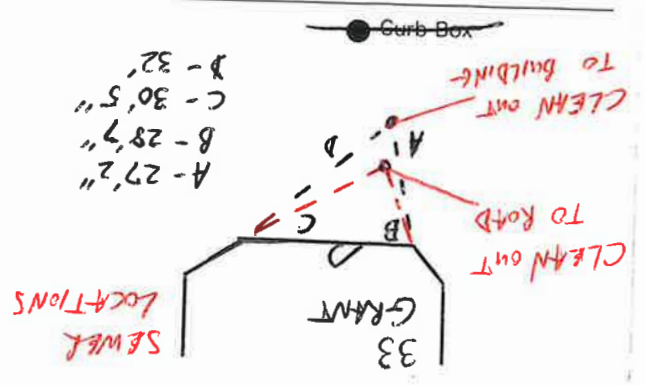

# LABOR AND MATERIALS

1	Copper } Connection		\$
	Lead }		
1	Curb } Cock		\$
	Valve }	in.	
	T.S. & V. }		
1	Service box { Short 3-1/2 x 4-1/2		\$
	Old returned { Long 4-1/2 x 5-1/2		
12	Ft. 3/4 in. { Copper		\$
	in. } Pipe at		
	Nipples	in. at	\$
	Bushings	to in. at	\$
	Red'g		
	Inc'g		
	Union	in. at	\$
	Meter	in. at	\$
			\$
	Compound Joints at		\$
	Maintenance Foreman		\$
	Hrs. Water Maint. Man - 1 at		\$
	Hrs. Water Maint. Man - 2 at		\$
	Hrs. Garage Foreman	at	\$
	Hrs. Labor	at	\$
	Hrs. Compressor at		\$
			\$
	Trucking		\$
	Pav't Patch		\$
			\$
			\$
			\$
			\$

GRANT

St. Ave. No. 33

Name of Owner

Labor and Mat'l. Report 19 30 Oct 6

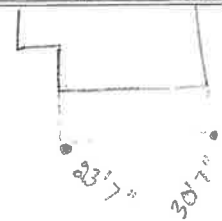

● Curb Box

4" Main

Elev. of Main at tap 4'

Gate at ●

● Gate at

● Curb Box

OLD TAP DISCONNECTED