

LABOR AND MATERIALS

1	Copper } Connection	3/4	\$
	Lead		
1	Curb } Cock	3/4 in.	\$
	Valve		
	T.S. & V.		
1	Service box } Short 3-1/2 x 4-1/2		\$
	Old returned } Long 4-1/2 x 5-1/2		
14	Ft. 3/4 in. } Copper		\$
	Pipe at		
	Nipples	in. at	\$
	Bushings	to in. at	\$
	Red'g		
	Inc'g		
	Union	in. at	\$
	Meter	in. at	\$
			\$
	Compound Joints at		\$
	Maintenance Foreman		\$
	Hrs. Water Maint. Man - 1 at		\$
	Hrs. Water Maint. Man - 2 at		\$
	Hrs. Garage Foreman	at	\$
	Hrs. Labor	at	\$
	Hrs. Compressor at		\$
			\$
	Trucking		\$
	Pav't Patch		\$
			\$
			\$
			\$
			\$

GRANT

St. Ave. No. 41-43

Name of Owner

TAX ID # 302.19-11-13

Labor and Mat'l. Report 19 27, June 21

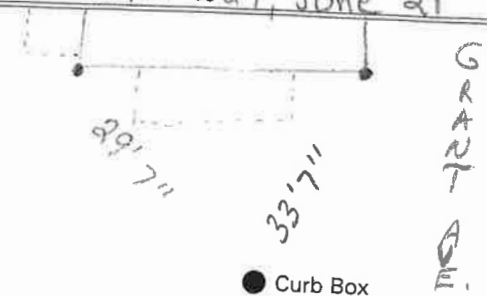

CRANDALL ST.

10" Main

Elev. of Main at tap 4'

Gate at ●

● Gate at

● Curb Box

OLD TAP SHUT OFF

TAP ON CRANDALL ST.