

LABOR AND MATERIALS

1	Copper } Connection	3/4	\$
1	Curb } Cock } 3/4 in.		\$
1	Service box } Short 3-1/2 x 4-1/2		\$
	Old returned } Long 4-1/2 x 3-1/2		\$
15	Ft. 3/4 in. } Copper } Pipe at		\$
	Nipples	in. at	\$
	Bushings	to in. at	\$
	Red'g		\$
	Inc'g		\$
	Union	in. at	\$
	Meter	in. at	\$
	Compound Joints at		\$
	Maintenance Foreman		\$
	Hrs. Water Maint. Man - 1 at		\$
	Hrs. Water Maint. Man - 2 at		\$
	Hrs. Garage Foreman at		\$
	Hrs. Labor at		\$
	Hrs. Compressor at		\$
	Trucking		\$
	Pav't Patch		\$
			\$
			\$
			\$
			\$
			\$

GRANT

St. Pr. Ave. No. 49

Name of Owner
TAX ID # 302.19-10-11

Labor and Mat'l. Report 19 27, June 10

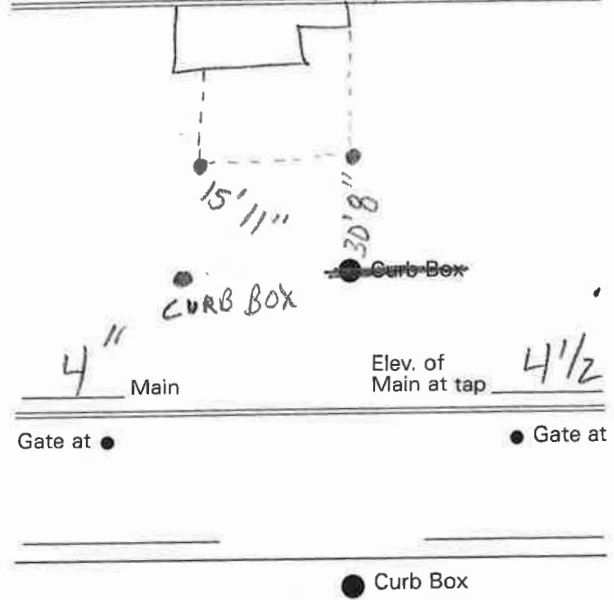

OLD DISCONNECTED