

LABOR AND MATERIALS

1	Copper	{ Connection	3/4		\$ 2.87
	Lead				
1	Curb	{ Cock Valve	3/4 in.		\$ 3.62
		{ T. S. & V.			
1	Service box	} Short 3 1/2 x 4 1/2 Long 4 1/2 x 5 1/2 Buff or Rdway			\$ 4.68
	Old returned				
26	Ft.	{ Copper	3/4 in.	Pipe at 32	\$ 8.32
		{ G. I.			
		{ C. I.			
	Nipples	in. at			\$
	Bushings	to in. at			\$
	Red'g	{ Coupl'gs	to in. at		\$
	Inc'g				
	Union	in. at			\$
	Meter	in. at			\$
	Lead Joints	at			\$
	Compound Joints	at			\$
	Hrs. Water Maint. Man-1	at			\$
7	Hrs. Water Maint. Man-2	at 1.07			\$ 7.14
	Hrs. Labor	at			\$
22	Hrs. Labor	at 91			\$ 20.02
2	Hrs. Compressor	at 1.20			\$ 2.40
	Compensation Ins. at \$ 2.18 per C.				\$ 1.59
	Trucking				\$ 2.00
	Pav't Patch				\$ 14.85
	<i>Tap by M. J. Quinn</i>				\$
					\$
					\$
	O'head				\$
					\$ 66.49

128

Grove

St. -
Pl. -
Ave. No. 30

Name of Owner

Johnson

Labor and Mat'l. Report

Nov 18 19 *19*

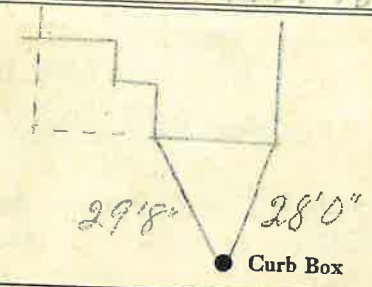

6 Main

Elev. of Main at tap *5/8*

Gate at ●

● Gate at

● Curb Box