

Labor and Materials

1	Copper } Connection		\$ 320	
1	Lead } Cock		\$ 100	
1	Curb } Valve	3/4 in.		
	T.S. & V.			
1	Service Box } Short 3' x 4'		\$ 140	
	Old returned } Long 4 1/2 x 5 1/2			
		Buff. or Rdway		
11	Ft. } in.	Copper } Pipe at	242	
		Galv. Iron }		
		Cast Iron }		
	Nipples	in. at	\$	
	Bushings	to in. at	\$	
1	Red g } Couplings	3/4 to in. at	\$ 15	
	Ins. }			
	Union	in. at	\$	
	Meter	in. at	\$	
	Lbs. Br. Stone	at	\$	
	Lbs. Sand	at	\$	
	Bags Cement	at	\$	
	Paving Brick } Mack	} at	\$	
				Red
				Asphalt
	Lead Joints	at	\$	
	Leadite Joints	at	\$	
7	Hrs. Foreman	62.5	\$ 438	
6	Hrs. Common Labor	50	\$ 350	
8	Hrs. Common Labor	40.6	\$ 325	
	Hrs. Mason	at	\$	
	Hrs. Mason's Helper	at	\$	
1	Hrs. Compressor	at	\$ 2.00	
	Compensation Ins.		\$ 28	
1	Trucking		\$ 1.80	
	Builders' Use of Water		\$	
<p><i>present patch to follow</i></p>			Total \$ 29.08	

2769

Labor and Material Report *Jan 13 1921*

no 33

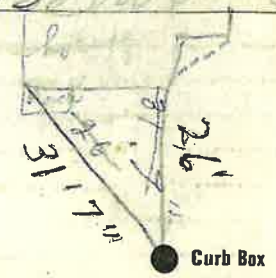

Main Elev. of Main at tap 5'

Gate at ● ● Gate at

● Curb Box

old top shut off.