

Labor and Materials

1	Copper } Connection	3		\$ 320
	Lead } Connection	3		
	Curb } Cock	1		
	Valve } T.S. & V.	1		\$ 150
	Service Box } Short 3 1/2 x 4 1/2			
	Old returned } Long 4 1/2 x 5 1/2			\$ 140
			Buff. or Rdway	
27	Ft. 3 1/2 in. } Copper			
	Galv. Iron } Pipe at			
	Cast Iron } Pipe at			
	Nipples		in. at	\$
	Bushings	3/4	to 1 in. at	\$ 07
	Red'g } Couplings	1/2	to 1 in. at	\$
	Inc'g } Couplings	1/2	to 1 in. at	\$
	Union		in. at	\$
	Meter		in. at	\$
	Lbs. Br. Stone		at	\$
	Lbs. Sand		at	\$
	Bags Cement		at	\$
	Paving Brick } Mack		at	\$
	Red } at			\$
	Asphalt } at			\$
	Lead Joints		at	\$
	Leadite Joints		at	\$
	Hrs. Foreman		at	\$
	Hrs. Common Labor		at	\$
	Hrs. Common Labor		at	\$
	Hrs. Mason		at	\$
	Hrs. Mason's Helper		at	\$
	Hrs. Compressor		at	\$
	Compensation Ins.			\$
	Trucking			\$ 100
	Builders' Use of Water			\$
	Total			\$

Labor and Material Report

19 27

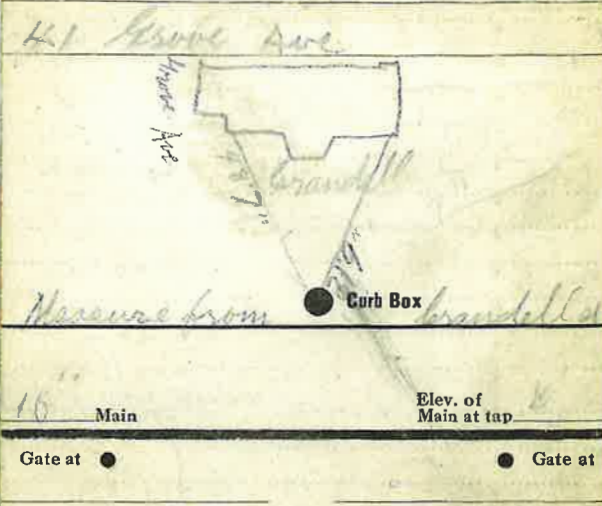

Old Tap shut off

Measure from Crandell St
48' 7" 31' 9"

Old tap shut off