

LABOR AND MATERIALS

_____ Copper } Connection _____ \$ _____
 _____ Lead }
 _____ Curb } Cock } _____ in. _____ \$ _____
 _____ Valve }
 _____ T.S. & V. }
 _____ Service box { Short 3-1/2 x 4-1/2 } _____ \$ _____
 _____ Old returned { Long 4-1/2 x 5-1/2 }
 _____ Ft. _____ in. { Copper } Pipe at _____ \$ _____
 _____ { G.I. }
 _____ { C.I. }
 _____ Nipples _____ in. at _____ \$ _____
 _____ Bushings _____ to _____ in. at _____ \$ _____
 _____ Red'g _____
 _____ Inc'g _____
 _____ Union _____ in. at _____ \$ _____
 _____ Meter _____ in. at _____ \$ _____
 _____ \$ _____
 _____ Compound Joints at _____ \$ _____
 _____ Maintenance Foreman _____ \$ _____
 _____ Hrs. Water Maint. Man - 1 at _____ \$ _____
 _____ Hrs. Water Maint. Man - 2 at _____ \$ _____
 _____ Hrs. Garage Foreman _____ at _____ \$ _____
 _____ Hrs. Labor _____ at _____ \$ _____
 _____ Hrs. Compressor at _____ \$ _____
 _____ \$ _____
 _____ Trucking _____ \$ _____
 _____ Pav't Patch _____ \$ _____
 _____ \$ _____
 _____ \$ _____
 _____ \$ _____
 _____ \$ _____
 _____ \$ _____

St. _____
 Pl. Grove
 Ave. No. 44

Name of Owner _____

Jan 29th 2015

Labor and Mat'l. Report 19

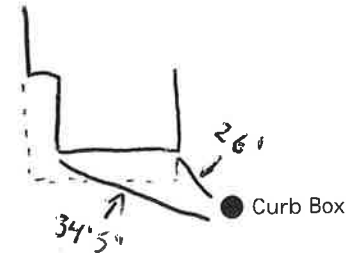

_____ Main _____ Elev. of Main at tap _____

Gate at ● _____ Gate at _____
3/4 copper 27 To main

● Curb Box

Labor and Materials

1	Copper } Connection	3/4	\$	3.20
	Lead } Connection	3/4	\$	
1	Curb } Cock Valve	1 1/2 in.	\$	1.00
		T. S. & V.		
1	Service Box } Short 3 1/2 x 4 1/2		\$	1.30
	Old returned } Long 4 1/2 x 5 1/2		\$	
		Buff. or Rdway		
27	Ft. 3/4 in. } Copper Galv. Iron } Pipe at		\$	5.94
		Cast Iron		
	Nipples	in. at	\$	
	Bushings	to in. at	\$	
1	Red'g } Couplings	to in. at	\$	1.5
	Inc'g }			
	Union	in. at	\$	
	Meter	in. at	\$	
	Lbs. Br. Stone	at	\$	
	Lbs. Sand	at	\$	
	Bags Cement	at	\$	
	Paving Brick } Mack Red Asphalt } at		\$	
	Lead Joints	at	\$	
	Leadite Joints	at	\$	
19	Hrs. Foreman	6 2 1/2	\$	8.75
15	Hrs. Common Labor	50	\$	7.50
1	Hrs. Common Labor	10 1/2	\$	41
	Hrs. Mason	at	\$	
	Hrs. Mason's Helper	at	\$	
1	Hrs. Compressor	at	\$	
	Compensation Ins.		\$	44
	Trucking		\$	1.00
	Builders' Use of Water		\$	
Total				\$29.69

27-161

Labor and Material Report *Sept 20* 1927

~~44~~ 44 Grove Ave

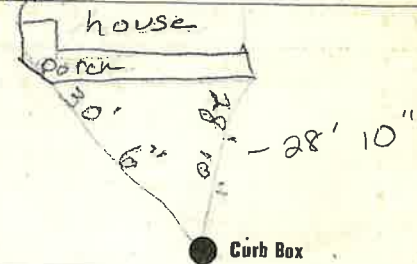

6" Main Elev. of Main at tap 5'
Gate at 3/4" copper 27' to main Gate at

Curb Box

old job shut off