

Labor and Materials

1	Copper } Connection ^{3/4"}	\$ 3.20
	Lead	
1	Curb { Cock Valve } ^{3/4"} in.	\$ 1.00
	{ F.S. & V. }	
1	Service Box { Short 3 1/2 x 4 1/2 } Old returned { Long 4 1/2 x 5 1/2 } { Buil. or Rdway }	\$ 1.30
1.0	Ft. ^{3/4"} in. { Copper } Pipe at	\$ 2.20
	{ Galv. Iron }	
	{ Cast Iron }	
	Nipples..... in. at.....	\$
	Bushings..... to..... in. at.....	\$
	Red'g } Couplings..... to..... in. at.....	\$
	Inc'g }	
	Union..... in. at.....	\$
	Meter..... in. at.....	\$
	Lbs. Br. Stone at.....	\$
	Lbs. Sand at.....	\$
	Bags Cement at.....	\$
	Paving Brick { Mack } { Red } { Asphalt }	\$
	Lead Joints at.....	\$
	Leadite Joints at.....	\$
2	Hrs. Foreman at ^{6 2/3}	\$ 1.25
8	Hrs. Common Labor at ^{40 5/8}	\$ 2.44
	Hrs. Common Labor at.....	\$
	Hrs. Mason at.....	\$
	Hrs. Mason's Helper at.....	\$
1	Hrs. Compressor at.....	\$ 1.50
	Compensation Ins.....	\$ 1.10
	Trucking.....	\$ 1.00
	Builders' Use of Water.....	\$
Total \$		14.99

28-57

Labor and Material Report June 15 1928

3/4 tap at 47 Grove Ave

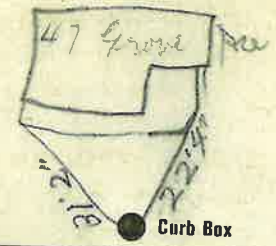

6" Main Elev. of Main at tap 4 ft

Gate at ● Gate at ●

● Curb Box

Old tap shut off